



HO TRAINS THAT DO MORE

[WWW.MTHHOTRAINS.COM](http://WWW.MTHHOTRAINS.COM)

80-2052-1  
80-2053-1  
80-2054-1  
80-2055-1  
80-2056-1  
80-2057-1  
80-2058-1  
80-2059-1

# HO VERANDA

FOR CURRENT PRICE AND AVAILABILITY  
GO TO [WWW.MTHTRAINS.COM](http://WWW.MTHTRAINS.COM), SELECT  
SERVICE THEN PARTS.



HO TRAINS THAT DO MORE

# HO VERANDA Body

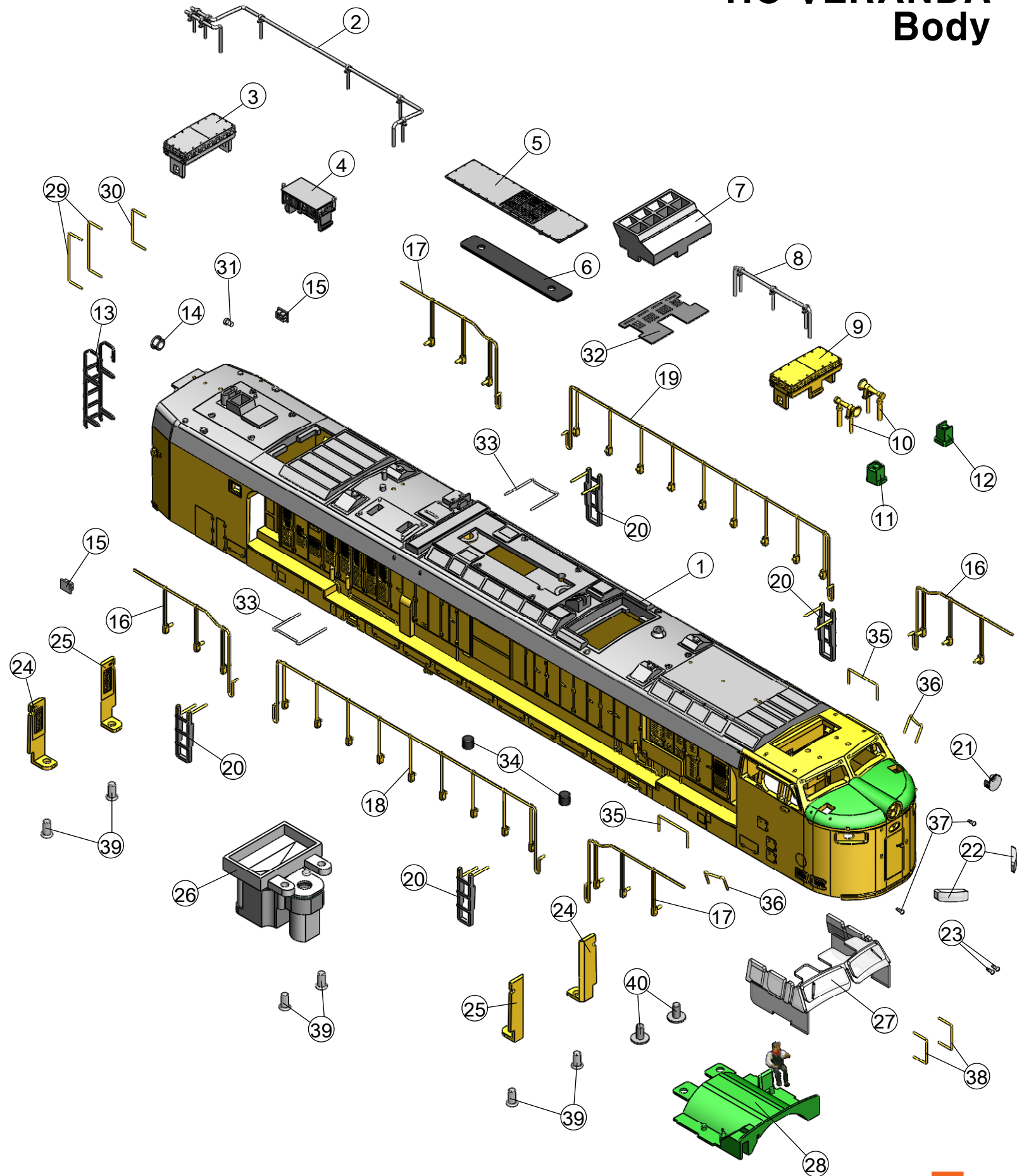

# UP Veranda (Body)

Callout	Description	Part #
1	SHELL, cab #70	fc-2602000070
1	SHELL, cab #73	fc-2602000073
1	SHELL, cab #66	fc-2602000066
1	SHELL, cab #63	fc-2602000063
2	PIPE HAND RAIL(A)	fc-2602002000
3	VENT ROOF(UP Gray)	fc-2602003000
4	ROOF PUM	fc-2602004000
5	ROOF COVER	fc-2602005000
6	PANEL, MAGNET	fc-2602006000
7	BIG BLOW VENT	fc-2602007000
8	PIPE HAND RAIL(B)	fc-2602008000
9	VENT ROOF(UP Yellow)	fc-2602009000
10	HORN	fc-2602010000
11	SAND HATCH-R	fc-2612001000
12	SAND HATCH-L	fc-2622001000
13	LADDER	fc-2642001000
14	LENS, REAR DOOR	fa-2642001000
15	LENS, SIDE	fa-2652001000
16	HAND RAIL(A)	fc-2652001000
17	HAND RAIL(B)	fc-2652002000
18	HAND RAIL( C)-R	fc-2612002000
19	HAND RAIL( C)-L	fc-2622002000
20	STEP	fc-2652003000
21	LENS, SIGNAL LIGHT	fa-2632001000
22L	LENS, X-70 NUMBER BOARD (left)	fa-2622000070
	LENS, X-73 NUMBER BOARD (left)	fa-2622000073
	LENS, X-66 NUMBER BOARD (left)	fa-2622000066
	LENS, X-63 NUMBER BOARD (left)	fa-2622000063
22R	LENS, X-70 NUMBER BOARD (right)	fa-2612000070
	LENS, X-73 NUMBER BOARD (right)	fa-2612000073
	LENS, X-66 NUMBER BOARD (right)	fa-2612000066
	LENS, X-63 NUMBER BOARD (right)	fa-2612000063
23	LENS, MARKER LIGHT	fa-2632003000
24	BODY PANEL(A)	fc-2652004000
25	BODY PANEL(B)	fc-2652005000
26A	SMOKE UNIT	aa-1600004
26B	FUNNEL, SMOKE UNIT	ih-1600001
26C	SCREW (M2.4 x 4.5mm/round head)	ia-1600029
27L	WINDOW GLASS, Left	fa-2612004000
27R	WINDOW GLASS, Right	fa-2612004000
28	INTERIOR	fc-2632001000
29	REAR HAND RAIL(A)	fc-2642002000
30	REAR HAND RAIL(B)	fc-2642003000
31	LENS, REAR	fa-2642003000
32	GRILL	fc-2602013000
33	SIDE HAND RAIL(A)	fc-2652006000
34	MAGNET	fc-2602014000
35	HAND RAIL(D)	fc-2602015000
36	SIDE HAND RAIL(B)	fc-2652007000
37	LENS, CLASSIFICATION LIGHT	fc-2632005000
38	FRONT HAND RAIL	fc-2632002000
39	SCREW(M2*4.0mm/Round Head)	ia-0000058
40	SCREW(M2*4.0mm/Washer Head)	ia-0000080

# HO VERANDA Chassis

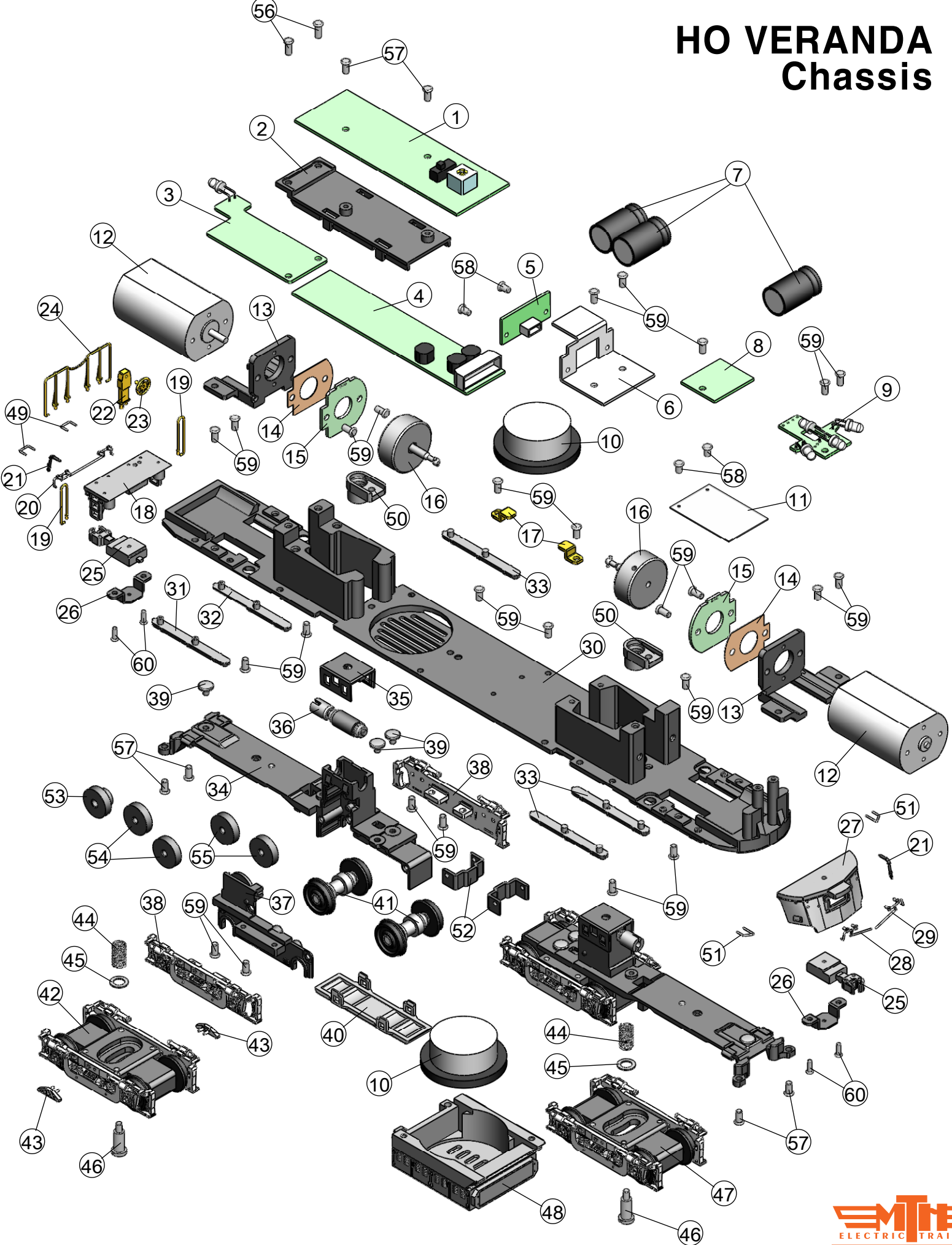



# UP Veranda (Chassis)

Callout	Description	Part #	Callout	Description	Part #
1	CONTROL, BOARD	ad-2602001000	52	WIRE COVER(B)	dh-2602004000
2	BRACKET, CONTROL BOARD	ih-2602001000	53	GEAR(A)	eg-2602006000
3	LAMP BOARD	ah-2602001000	54	GEAR(B)	eg-2602007000
4	PS3 BOARD	ae-2603CS0006	55	GEAR( C)	eg-2602008000
4	PS3 BOARD, hirose connector 1st build	ae-2603h00006	56	SCREW(M2*4.0mm/Round Head)	ia-0000058
5	4PIN BOARD	ah-2602002000	57	SCREW(M2*3.0mm/Round Head)	ia-0000018
6	HEAT SINK, DIESEL BOARD	ai-2602001000	58	SCREW (M2.0*4.0mm/T.Round Head)	ia-2602003000
7	SUPER CAP	bb-0000062	59	SCREW(M2.0*5.0mm/Round Head)	ia-0000119
8	FRONT BOARD	ah-2602003000	60	SCREW (M1.4*4.0mm/T.Round Head)	ia-2602002000
9	LAMP BOARD	ah-2602004000	61	DRIVE SHAFT	eh-2602002000
10	SPEAKER(VECO)	bf-2602001000			
11	WIRE COVER(A)	dh-2602001000			
12	MOTOR	be-2602001000			
13	MOTOR MOUNT	bi-2602001000			
14	INSULATOR, MOTOR MOUNT	bd-2602001000			
15	TACH BOARD	ah-2602005000			
16	FLY WHEEL	be-2602002000			
17	BRACKET, SPEAKER	ih-2602002000			
18	PILOT(Rear)	dg-2642001000			
19	PILOT HAND RAIL(A)	dg-2652001000			
20	LIFTING LEVER(Rear)	dg-2642002000			
21	AIR HOSE	dg-2602001000			
22	BRACKET, BRAKE HANDLE	ih-2642001000			
23	BRAKE HANDLE	dg-2642003000			
24	PILOT HAND RAIL(B)	dg-2642004000			
25	ELECTRIC COUPLER	dd-2602001000			
26	BRACKET, ELECTRIC COUPLER	ih-2602003000			
27	PILOT(Front)	dg-2632001000			
28	LIFTING LEVER(Front)-R	dg-2612001000			
29	LIFTING LEVER(Front)-L	dg-2622001000			
30	FRAME	dh-2602002000			
31	AIR TANK(A)-R	fc-2612003000			
32	AIR TANK(A)-L	fc-2622003000			
33	AIR TANK(B)	fc-2602011000			
34	GEAR BOX(A)	eg-2602001000			
35	GEAR BOX COVER	eg-2602002000			
36	WORM GEAR	eh-2602001000			
37	GER BOX(B)	eg-2602003000			
38	TRUCK SIDE	db-2652001000			
39	INSULATOR PIN	ig-2602001000			
40	GEAR BOX UNDER COVER	eg-2602004000			
41	WHEEL ASS'Y	dc-2602001000			
42	TRUCK(Rear)	da-2642001000			
43	TRUCK SIDE DETAIL	da-2652001000			
44	SPRING(4.5*7.00mm/STS)	ie-2602001000			
45	WASHER(6.5-4.1H-.4T)	id-2602001000			
46	SCREW (M2.0*7.4*3.2mm/Straight Head)	ia-2602001000			
47	TRUCK(Front)	da-2632001000			
48	BATTERY BOX	bg-2602001000			
49	PILOT HAND RAIL( C)	dg-2642005000			
50	GEAR BOX BOLSTER	eg-2602005000			
51	PILOT HAND RAIL(D)	dg-2632002000			

# HO VERANDA Tender

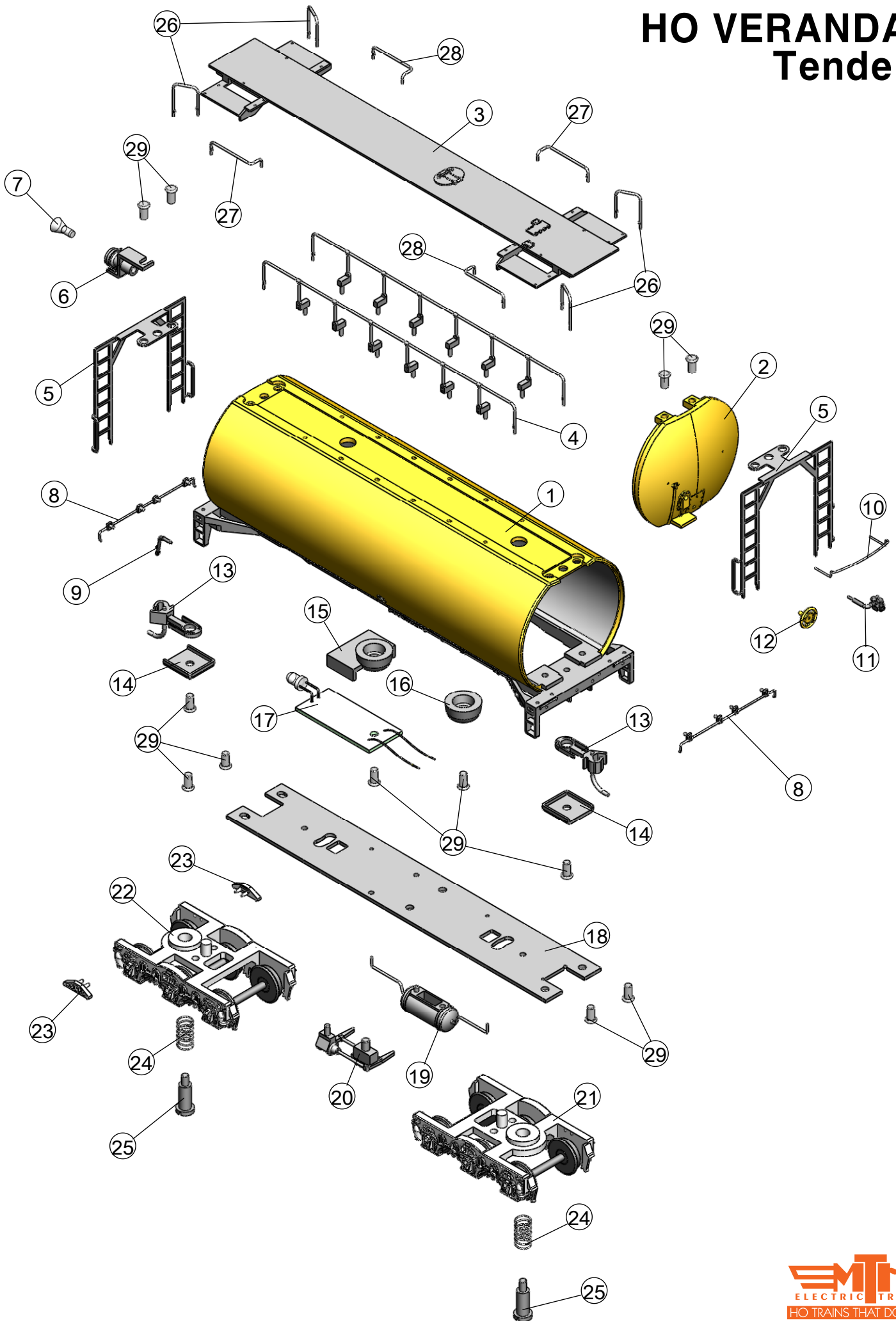

# UP Veranda (Tender)

Callout	Description	Part #	Callout	Description	Part #
1	TENDER BODY, #70	GA-2602000070			
1	TENDER BODY, #73	GA-2602000073			
1	TENDER BODY, #66	GA-2602000066			
1	TENDER BODY, #63	GA-2602000063			
2	TENDER BODY COVR, #70	ga-2602002070			
2	TENDER BODY COVR, #73	ga-2602002073			
2	TENDER BODY COVR, #66	ga-2602002066			
2	TENDER BODY COVR, #63	ga-2602002063			
3	RUN BOARD	ga-2602003000			
4	HAND RAIL(A)	ga-2602004000			
5	LADDER	ga-2602005000			
6	BACK UP LIGHT	cf-2602001000			
7	LENS, BACK UP LIGHT	fa-2642002000			
8	LIFTING LEVER	ga-2602006000			
9	AIR HOSE	ga-2602007000			
10	HAND RAIL(B)	ga-2602008000			
11	PIPE	ga-2602009000			
12	BRAKE HANDLE	ga-2602010000			
13	MACHINERY COUPLER	dd-2602002000			
14	COUPLER BASE	ga-2602011000			
15	RUN BOARD FIXER	ga-2602012000			
16	RUN BOARD FIXER	ga-2602003000			
17	LAMP BOARD	ah-2602006000			
18	FLOOR	dh-2602003000			
19	AIR TANK	ga-2602014000			
20	BRAKE CYLINDER	ga-2602015000			
21	TRUCK(Front)	da-2642002000			
22	TRUCK(Rear)	da-2632002000			
23	TRUCK SIDE DETAIL	da-2652001000			
24	SPRING(4.5*7.0mm/STS)	ie-2602001000			
25	SCREW (M2.0*7.4*3.2mm/Straight Head)	ia-2602001000			
26	HAND RAIL(C )	ga-2602016000			
27	HAND RAIL(D)	ga-2652001000			
28	HAND RAIL(E)	ga-2652002000			
29	SCREW(M2*4.0mm/Round Head)	ia-0000058			