

RAILKING
READY-TO-RUN™
sets
THE COMPLETE SOLUTION

www.railking.com

2-8-0 Steam Freight Set

Operation Manual

LOCOSOUND
Loco Speed Control

RAILKING
By MTH Electric Trains

Thank you for purchasing this RailKing product.
PLEASE READ BEFORE USE AND SAVE

Table of Contents

SetUp Checklist	3
Getting Started	4
AssemblingRealTrax	4
PluggingintheTransformer	4
Lubricatingthe Engine	5
Priming theSmoke Unit	5
CouplingtheEngine and Cars	6
Remote C o n t r o l	6
Basic Operation	7
Operation Buttons	7
Speed Control	8
Direction Lock	8
Proto-Cast and Proto-Dispatch	9
ManualVolume Control	10
Maintenance	11
Care of Remote Control	11
Lubricationand Greasing Instructions	11
CleaningtheWheels, Tiresand Track	12
LocomotiveTraction Tire Replacement	12
Smoke UnitMaintenance	12
LocomotiveLight Bulb Replacement	13
CabooseLightBulb Replacement	14
RailWare Interactive CDROM	15
Troubleshooting	16
Compatibility	17
Transformer Compatibility Chart	17
Exploded View Parts	18
Service and Warranty Information	

CAUTION:ELECTRICALLYOPERATEDPRODUCT:

Notrecommendedforchildrenunder10years ofage.M.T.H.recommendsadultsupervisionwithchildrenages10-16. Aswithallearlectricproducts, precautionsshould beobservedduringhandlingandusetoreducetherisk ofelectric shock.

WARNING: Whensusingelectricalproducts, basicsafetyprecautionsshouldbeobserved,includingthefollowing:

Read thismanualthoroughlybeforeusingthisdevice.

- M.T.H. recommends that all users and persons supervising use examine the hobby transformer and other electronic equipment periodically for conditions that may result in the risk of fire, electric shock, or injury to persons, such as damage to the primary cord, plug blades, housing, output jacks or other parts. In the event such condition exist, the train set should not be used until properly repaired.
- Do not operate your layout unattended. Obstructed accessories or stalled trains may overheat, resulting in damage to your layout.
- This train set is intended for indoor use. Do not use if water is present. Serious injury or fatality may result.
- Do not operate the hobby transformer with damaged cord, plug, switches, buttons or case.
- The transformer was designed to operate on regular US household current (120 volt, 50-60 Hertz). Do not connect to any other source of power.
- To avoid the risk of electrical shock, do not disassemble the transformer unit. There are non-user-serviceable parts inside. If the unit is damaged contact M.T.H. Service for instructions.
- The transformer is equipped with an internal circuit protector. If the circuit protector trips, unplug the power cord from the electrical wall outlet, check your layout for any short circuits. The circuit breaker will reset automatically when the shorts are removed from the circuit.
- Unplug the transformer from the electrical wall outlet when not in use.
- Do not use this transformer for other than its intended purpose.

Transformer Ratings:

Input: 120 VAC, 60Hz Only, Output: 21VAC, 3.75A 78VA

Set Up Checklist

- Assemble RealTrax®
- Connect the transformer
- Lubricate the engine
- Prime the SmokeUnit
- Place the engine and cars on the track and couple them together
- Position remote lock-on lens
- Apply power to run as described in the Basic Operation section of these instructions.

Set Includes



Steam Engine with Loco-Sound™



Steam Tender



8-Pieces
O-31 Curve RealTrax



Box Car



Lock-On

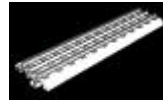

4-Pieces
Straight RealTrax



Video



Caboose

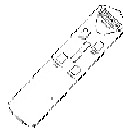

Remote Control



or
Controller with wire harness

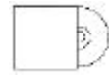

CD-Rom

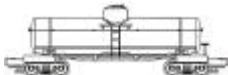

Tank Car

Tools Needed



Phillips Screwdriver



Pliers



Scissors



Cotton Swab or Rag



RailKing Maintenance Kit or
Light Household Oil and Bearing Grease

You can obtain replacement parts and replacement instructions from the M.T.H. Parts Department

e-mail: parts@methking.com

phone: 410-381-2580

mail: 7020 Columbia Gateway Drive, Columbia MD 21046-1532

Getting Started

Assembling RealTrax®

The quick connectors and built-in roadbed allow you to set up RealTrax anywhere, including carpeted surfaces.

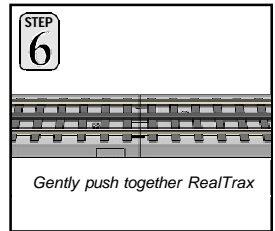
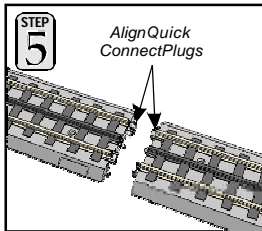
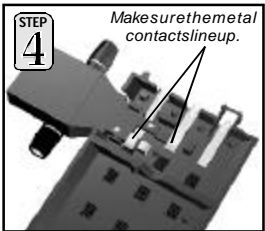
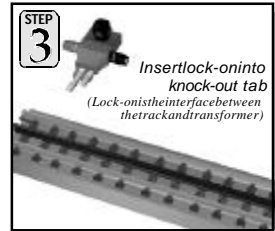
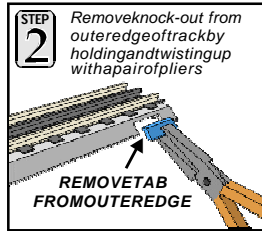
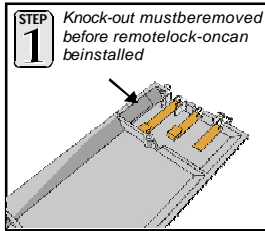

Connecting Track Clips

If you prefer not to screw your track to the table for a permanent layout, use the enclosed track clips on adjoining curved RealTrax sections to secure them in place.

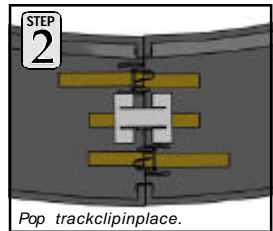
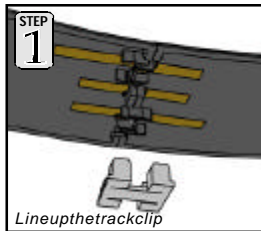

Connecting the Transformer

The 75-watt power supply included with this set provides an easy-to-use, safe power source for AC-powered trains and accessories.

- Plug the wire from the transformer into the remote lock-on's center port, then plug the transformer into the wall outlet.
- Unplug when not in use.

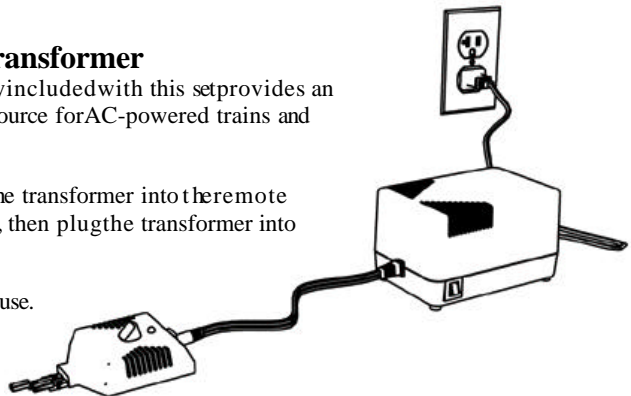

Lubricating the Engine

Lubricate all exposed moving parts before operating using a multi-purpose, plastic-compatible oil (available with M.T.H.'s Maintenance Kit, sold separately) or a light household oil. Follow the lubrication points.

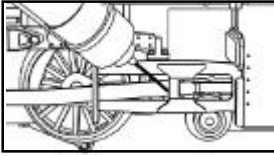

Lubricate Valve Gear

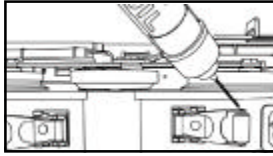

Lubricate Pick-Up Rollers
(Do Not Oil the Flat Part of Pick-Up Rollers)

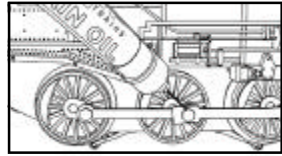

Lubricate Side Rods

Priming the Smoke Unit

You should prime the smoke unit with smoke fluid before operating. Add 15-20 drops of smoke fluid from the included pipette through the smoke stack, then gently blow into the stack to eliminate any air bubbles in the fluid.

If you choose not to prime the unit with fluid, turn the smoke unit switch located under the tender to the OFF position. **Running the engine without a primed smoke unit may cause damage.** See the "Proto Smoke Unit Operation" section of this book for more information on smoke unit maintenance.

Add 15-20 Drops
Smoke Fluid

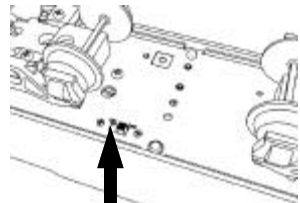
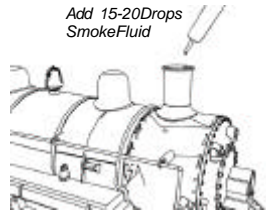

Smoke Unit
ON/OFF Switch



Running the engine without a primed smoke unit may cause damage

Coupling the Engine and Cars

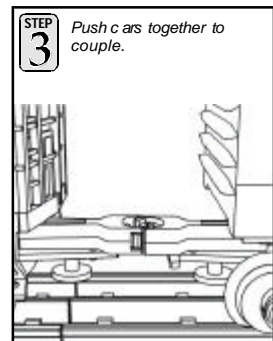
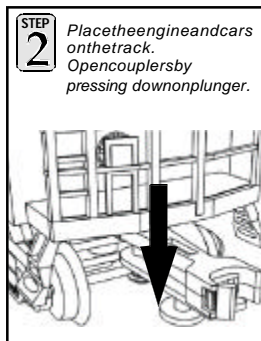
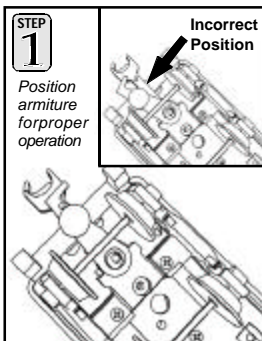

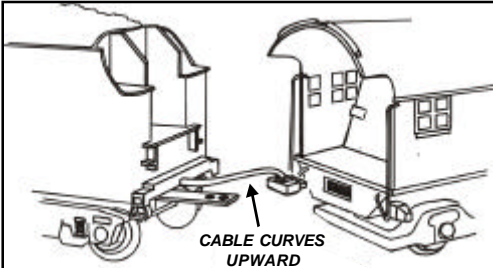

- Plug tender plug into boiler socket at the back of cab.
- Connect the drawbar between the engine and tender.



**DONOT CONNECT
This Engine To A
Tender From
Another Engine; It May
Cause Serious Damage.**

Look at the bottom of the engine and tender where each will have a color-coded stamp. If they match you may connect those two pieces; if not, don't.

Remote Control

The remote and lock-on are designed for use with moderate power supplies such as the one included with this set. It is compatible with virtually any manufacturer's engines.

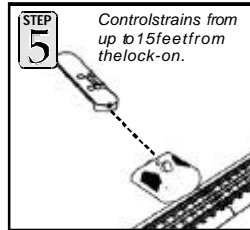
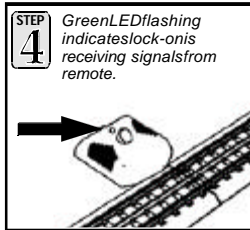
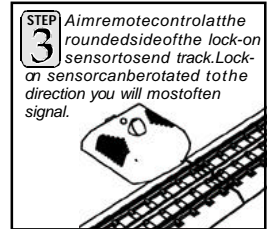
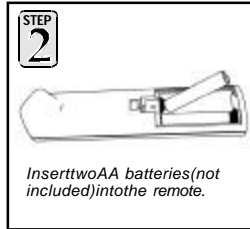
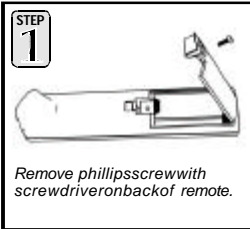

Note: The RailKing[®] Remote Control and Remote Lock-on will not operate engines equipped with pre-1997 versions of Proto-Sound[®] or with Proto-One, Proto-Plus, Proto-Deluxe,™ aftermarket systems.

Basic Operation

Throttle Up Throttle up the power to your track by pressing the top end of the Throttle Control Rocker Switch firmly for about 5 seconds, until the engine's headlight and lighted cars bum bright. Then put the engine in motion by firmly pressing the Direction button (hold it for approximately 1 second) on your remote once. If the engine does not begin to move as soon as you firmly press the Direction button, you may not have sent enough voltage to the track to make the train move. Press the throttle up for a few more seconds until the train begins to move.

To increase or decrease track voltage, and therefore train speed, press the throttle control rocker switch. Pressing the top end of the throttle will increase voltage and speed. Pressing the bottom end of the throttle will decrease voltage and speed.

The engine will maintain the speed you set after you release the throttle until you press it again to change the voltage and speed.

Bell - To sound the bell, firmly press and release the Bell button. To turn the bell off, press and release the Bell button again. The bell will continue to ring from the time you turn it on until you press and release the button again to turn it off.

Emergency Stop Press the Emergency Stop button and all trains on the track controlled by the remote will stop until you reapply voltage. This is an easy way to shut down your trains at the end of a session or to stop suddenly if the train's path becomes obstructed.

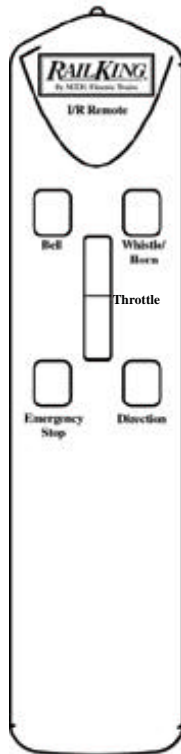

Horn/Whistle - To sound the horn, firmly press the Horn/Whistle button. The horn will sound for as long as you continue to depress the button. It will stop when you release the button.

Direction Your train is programmed to start in neutral. The train will always cycle neutral-forward-neutral-reverse with each press and release of the direction button. The engine is programmed to restart in neutral each time the track voltage is turned off for 25 seconds or more.

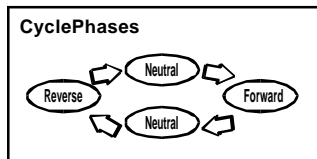

Speed Control

M.T.H. engines equipped with Loco-Sound have speed control capabilities that allow the engine to maintain a constant speed up and down grades and around curves, much like an automobile cruise control. You can add or drop cars on the run, and the engine will maintain the speed you set.

While the engine is programmed to start with the speed control feature activated, you can opt to turn it off. This means the engine's speed will fall as it labors up a hill and increase as it travels downward. It is also affected by the addition or releasing of cars while on the run. To maintain a constant speed when speed control is turned off, you need to adjust track voltage yourself.

To turn speed control on and off, put the engine in neutral, then quickly tap the transformer's Whistle button one time then quickly tap the Bell button two times, allowing approximately ½ second to lapse between each quick button press. Repeat the 1 whistle, 2 bells code to return to the other condition. **You will want to do this during the initial neutral upon start-up if you ever couple this engine to another engine that is not equipped with speed control to avoid damaging the motors in either engine.** Each time you shut down the engine completely, it will automatically turn speed control on.

Timing Chart				
Press Whistle Short & Firm	½ Sec. Pause	Press Bell Short & Firm	½ Sec. Pause	Press Bell Short & Firm
Total Time Lapse: 1 ½ Seconds				



Place Engine into Neutral



=

Speed Control Repeat to Return to Normal Condition

Direction Lock

You can lock your engine into a direction (forward, neutral, or reverse) so that it will not change directions. To do this, put the engine into the direction you want or into neutral, to lock it into neutral, run it at a very slow crawl (as slowly as it will move without halting), and quickly but firmly tap the Whistle button once followed by three quick taps of the Bell button, allowing approximately ½ second to lapse between each quick button press. The engine will not change direction (including going into neutral) until you repeat the 1 whistle, 3 bells code to return the engine to its normal condition, even if the engine is kept without power for extended periods of time.

Place Engine into Desired Direction



=

Direction Lock Repeat to Return to Normal Condition

Proto-Cast and Proto-Dispatch:

When used with the remote lock-on included in this set, Loco-Sound equipped engines gain Proto-Cast™ and Proto-Dispatch™ features.

Proto-Cast:

Allows you to play audiorecordings through your engine's speakers. You must supply the audio source (a small portable CD/tape player is sufficient) and a male-to-male mini cable (1/8" plug, like that used for the headset with a portable CD/tape player) to connect your audio source to the remote lock-on.



To use Proto-Cast

- Plug the mini-cable *first* into your audio source (usually into the headphone jack)
- Plug Cable into the "Audio" port on the right side of the remote lock-on.
- Adjust the volume. If engine sounds keep breaking through the recorded sounds, increase the volume on the audio source.

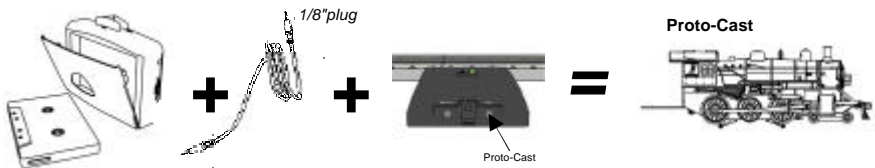

Proto-Dispatch:

This feature allows you to broadcast your own voice through your engine's speakers. You must supply the microphone and a mini cable (1/8" plug, like that used for the headset with a portable CD/tape player) to connect your microphone to the remote lock-on.



To use Proto-Dispatch

- Mini-cable attached to the microphone must be a 1/8" plug.
- Plug the "Mic" into the proto-dispatch port on the left side of the remote lock-on and speak into the microphone.



When these features are in use, the locomotive's own sounds (engine sounds and bells, whistles, and horns) will be muted so that only the sounds you broadcast will be heard. Because these two features are voice activated, there will be a several second delay after you stop speaking into the microphone or turn off the audio source before the engine sounds resume. To stop using the feature and return to normal operation, unplug the cable from the lock-on jack.

If using parallel tracks with multiple Loco-Sound equipped engines, Proto-Cast and Proto-Dispatch transmissions from one track may be picked up by the other nearby engines.

If you experience popping and interference when using Proto-Cast or Proto-Dispatch, try cleaning the track with denatured alcohol as described in the "Cleaning the Wheels, Tires and Track" section of this booklet.

NOTE: M.T.H. does not recommend using Proto-Cast and Proto-Dispatch at the same time.

Manual Volume Control

To adjust the volume of all sounds made by this engine, turn the master volume control knob located under the tender clockwise to increase the volume and counter-clockwise to decrease the volume.

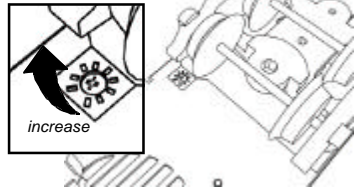

Maintenance

Care of the Remote Control

To ensure trouble-free operation:

- Do not drop the remote. It can damage the delicate electronics inside.
- Remove batteries before storing for extended periods.
- Any attempt by anyone other than an authorized M.T.H. repair person to open and repair the handheld transmitter or lock-on may result in damage and the loss of warranty protection.
- If your train responds inconsistently, replace old batteries with fresh ones. Do not mix old and new batteries.

Lubrication Instructions

The engine should be oiled and greased in order to run properly.

Regularly lubricate all side rods and linkage components and pickup rollers to prevent squeaking. Use light household oil, such as that found in M.T.H.'s maintenance kit. Do not overoil. Use only a drop or two on each pivot point.

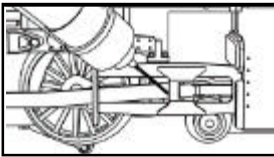

Lubricate Valve Gear

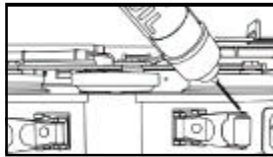

Lubricate Pick-Up Rollers
**(Do Not Oil the Flat Part of
Pick-Up Rollers)**

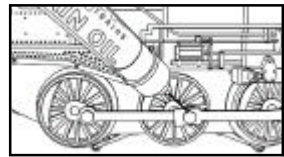

Lubricate Side Rods

Greasing Instructions

The locomotive's internal gearing was greased at the factory. Grease engine every 50 hours of use or one year. Use a lithium based grease and follow the greasing instructions.

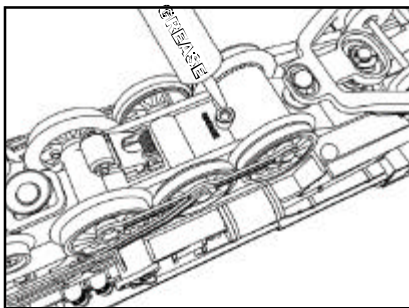

- Remove the screw from the chassis to open the grease port.
- Insert the grease tube tip into the port and squeeze the tube once or twice to add grease to the gearbox.
- Wipe off any excess grease and replace the phillips screw securely.

Cleaning the Wheels, Tires and Track

Periodically check the locomotive wheels and pickups for dirt and buildup, which can cause poor electrical contact and traction and prematurely wear out the neoprene traction tires. Wheels and tires can be cleaned using denatured (not rubbing) alcohol applied with a cotton swab.



To clean the track, use RailKing Track Cleaning Fluid and a clean rag or denatured (not rubbing) alcohol. Unplug the transformer and wipe the rails of the track, turning the rag frequently to ensure that you are using clean cloth on the rails. Because the manufacturing process leaves a coating on RealTrax center rail, you should clean the rails after the first 30 minutes of use (you may notice an electrical smell during initial use as the coating wears off; this is normal). Thereafter, keep an eye on the track and clean it when it gets dirty to ensure good electrical contact and to lengthen the life of the tires.

Traction Tire Replacement Instructions

Your locomotive is equipped with two neoprene rubber traction tires on the rear set of flanged drivers. While these tires are extremely durable, you may need to replace them at some point.

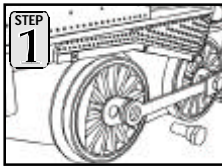

- Remove the side rods (the rods that connect each drive wheel to the other) from the wheels in order to slip the new tire over the grooved drive wheel. These screws can be loosened with a 5mm nut driver.
- Clean the groove using a cotton swab and denatured alcohol.

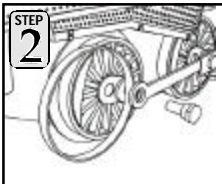

- Make sure the old tire has been completely removed from the groove in the drive wheel, using a razor blade or small flathead screwdriver to pry away any remains.
- Clean the groove using a cotton swab and denatured alcohol.
- Slip the new tire onto the wheel. You may find it useful to use two small flathead screwdrivers to stretch the tire over the wheel.
- If you twist the tire while stretching it over the wheel, you will need to remove and reinstall the tire. Otherwise your engine will wobble while operating.
- Make sure the tire is fully seated inside the groove. Use a razor blade to trim away any excess tire that doesn't seat itself inside the groove properly.

ProtoSmoke® Unit Operation

This steam locomotive contains a smoke unit that outputs smoke through the smokestack on the boiler of the engine. The smoke unit is essentially a small heating element and wick that soaks up and then heats a mineral oil-based fluid that emits a harmless smoke. The smoke is then forced out of the stack by a small electric fan.

With a few easy maintenance steps, you should enjoy trouble-free smoke unit operation for years.

- When preparing to run this engine, add 15-20 drops of smoke fluid through the smokestack. We recommend M.T.H. ProtoSmoke, Seuthel, LGB, or LVTS fluids (a

small pipette of ProtoSmoke fluid is included). Do not overfill the unit or the fluid may leak out and coat the interior engine components.

- If you choose not to add the fluid (or have already added the fluid but choose to run smoke-free), turn off the smoke unit switch located under the tender body. **Failure either to add fluid to the unit or to turn it off may damage the smoke unit heating element and/or wicking material.**

Add 15-20 Drops
Smoke Fluid

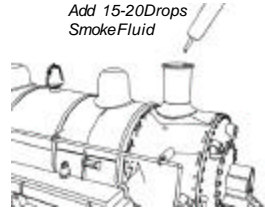

Running the engine without a primed smoke unit may cause damage

- When the smoke output while running the engine begins to diminish, add another 10-15 drops of smoke fluid or turn the smoke unit off.
- When storing the unit for long periods of time, you may want to add about 15 drops of fluid to prevent the wick from drying out.
- After removing the engine from storage, add another 25 drops of fluid, letting the wick soak up the fluid for 15 minutes prior to operation.

If you experience poor or no smoke output when the smoke unit is on and has fluid, check the wick to see if it has become hard, blackened, and unabsorbent around the heating element. Remove the boiler as shown below. Remove the smoke unit inspection cover from the locomotive's body (see right). After removing the chassis and inspection cover screws, lift the inspection plate away and inspect the wick. If it is darkly discolored and hard, it should be replaced. When priming new wick add 40 drops.

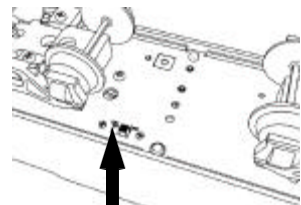

Smoke Unit
ON/OFF Switch



Smoke Unit Cover



Wick in
Poor
Condition



Wick in
Good
Condition

Locomotive Light Bulb Replacement

To replace the light bulb in the locomotive, follow the boiler removal instructions below.

STEP
1

Remove the six Phillip screws from the chassis then lift the body away from the chassis.

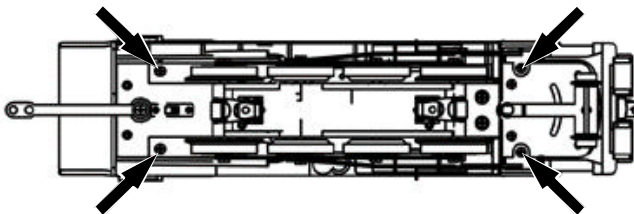

STEP 2

Once the locomotive boiler has been removed from its chassis, locate the bulb bracket as seen in the illustration on the right and rotate the headlight bulb counter-clockwise to remove.

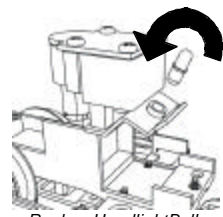

Replace Headlight Bulb

Caboose Light Bulb Replacement

To replace the interior light bulbs follow these instructions and see the diagrams below.

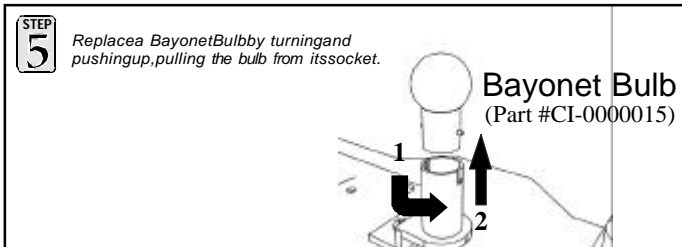
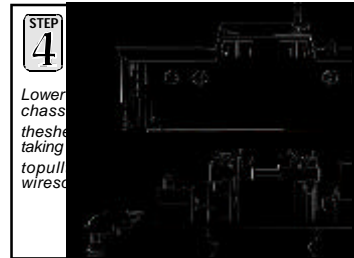
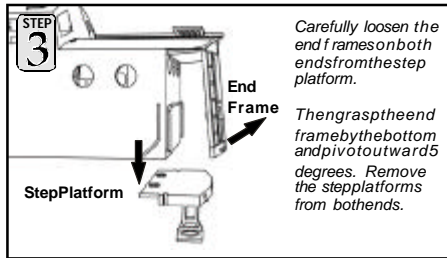
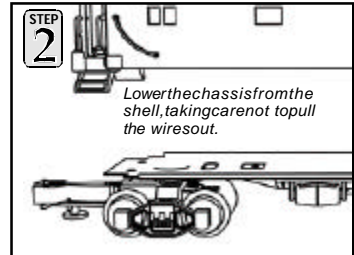
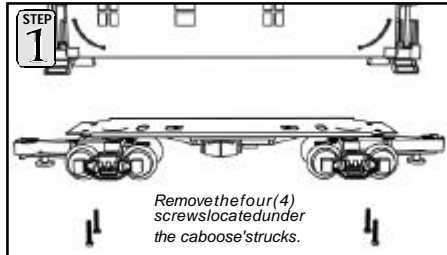

Quick-Start Video

The included VHS Quick-Start video demonstrates the start-up and basic operation of this set as well as other information about model railroading. You may find it helpful to view the video before operating this set.

RailWare Interactive CD ROM

M.T.H. provides a free RailWare CD ROM in each Ready-To-Run set. It is full of helpful information on M.T.H. product history, track planning software, a dealer finder, and information and video clips on Loco-Sound and Proto-Sound 2.0. Follow the directions below to use the CD ROM.

Minimum System Requirements: Pentium 100, 16MB RAM, Windows 95 or later, CD ROM drive, SoundCard, display properties set to greater than 256 colors. The CD will not work on a Mac OS unless you run VirtualPC®.

Running RR-Track Software

You may run the RR-Track software directly off of the CD ROM or you may install the software to your hard drive.

1. On the Desktop, click on the icon that says My Computer.
2. Find your CD ROM drive.
3. With the M.T.H. CD ROM in the drive, double click on the icon for the CD ROM drive.
4. Find the folder on the CD ROM entitled INSTALLATION.
5. Choose the folder inside entitled RRTRAXSETUP.
6. Run the file in that folder called SETUP.EXE and follow the directions it provides.

The program may ask you for a registration code. If it does type in "M.T.H." and it will run.

Additional track libraries can be obtained directly from RR-Track. See their website for more information www.rtrack.com.

Installing Adobe Acrobat Software

To read some of the electronic documents included on the CD ROM, you will need to install the Adobe Acrobat Reader® if it is not already on your computer. To install the software:

1. On the Desktop, click on the icon that says My Computer.
2. Find your CD ROM drive.
3. With the M.T.H. CD ROM in the drive, double click on the icon for the CD ROM drive.
4. Find the folder on the CD ROM entitled INSTALLATION.
5. Choose the folder inside entitled ACROBATREADER.

*If you are running Windows 95, 98 or NT choose the folder 32BIT. Run the file AR32E301.EXE and follow the directions it provides.

If you have problems you cannot resolve by using these directions, contact custserv@nth-railking.com or call 410-381-2580 for further help.

Troubleshooting Loco-Sound™ Problems

Although Loco-Sound has been designed and engineered for ease of use, you may have some questions during initial operation. The following table should answer most questions. If your problem cannot be resolved with this table, contact M.T.H. for assistance (e-mail: service@mth-railking.com; telephone: 410-381-2580; fax: 410-423-0009; mail: 7020 Columbia Gateway Drive, Columbia MD 21046-1532).

Starting Up	Remedy
When I first turn the power on, the engine will not begin to run.	This is normal behavior. To prevent accidental high-speed start-ups, Loco-Sound is programmed to start up in neutral any time track power has been turned off for several seconds. See the "Basic Operation" section for more details.
The engine will not start after I press the Direction button.	You may not be sending enough power to the track to power the engine. Press the throttle up for a few more seconds to increase track power.
Whistle	Remedy
I can't get the whistle to blow when I press the whistle button.	You may be pressing the button too quickly. Try pressing the whistle button more slowly, taking approximately one full second to fully depress the button.
Bell	Remedy
I can't get the bell to ring when I press the bell button.	You may be pressing the button too quickly. Try pressing the bell button more slowly, taking approximately one full second to fully depress the button.
Lock-out	Remedy
I can't get the engine to run after I power up the transformer. It's still with the engine sounds running.	The engine may be locked into the neutral position. Follow the procedure in the "Lock into a Direction" section to unlock the engine's direction.
The engine won't lock into forward, neutral, or reverse.	The engine speed must be below 10 scale mph (approx. 10 volts or less in conventional mode).
Volume	Remedy
The sounds seem distorted, especially when the Horn or bell is activated.	Loco-Sound volume is set too high. Turn the volume control knob on the bottom of the chassis counter-clockwise to reduce the volume.
No sound.	Volume is set too low, adjust volume control knob on the bottom of the chassis clockwise to increase the volume or check connector to speaker.
Proto-Cast and -Dispatch	Remedy
When I try to play music or my voice through my engine's speakers, there is popping and interference.	Clean the track with denatured alcohol, as described in the "Cleaning the Wheels, Tires, and Track" section of this book.
My Proto-Cast sounds play too quietly or unclearly.	Unplug the cable between the audio source and the remote lock-on. Re-plug it into the audio source first, then into the lock-on, pushing firmly to make sure it is fully installed.
When I try to play Proto-Cast, the engine's sounds keep breaking in on my recording.	Your recording may be playing too quietly to trigger the engine to stop playing its own sound set. Turn up the volume of the audio source you are using.
When I run two Loco-Sound engines on tracks near each other, the Proto-Cast and Dispatch sounds play from both engines, not just from the one connected to the audio source or microphone.	This is normal behavior. Because Loco-Sound uses radio waves to transmit the sound to the engine, other Loco-Sound engines in the same range will also pick up the sound. Try moving one of the sets.

Compatibility

While this Ready-To-Run set is equipped with everything you need to operate it, the design allows flexibility. The train will operate on any traditional O-31 or larger O Gauge track system, including the RealTrax® included with this set or traditional tubular track. It is also compatible with most standard AC transformers, including the hobby transformer packaged with your set.

Transformer Compatibility and Wiring Chart

Note that many of the operational commands described in these instructions require a bell button, so if you are using a transformer other than the one included in this set and your transformer does not have its own bell button, you should consider adding one to get the full benefit of the system.

Transformer Model	Center Rail	Outside Rail	Min/Max. Voltage	Power Rating	Transformer Type
MTH Z-500	Red Terminal	Black Terminal	0-18v	50-Watt	Electronic
MTH Z-750	Red Terminal	Black Terminal	0-21v	75-Watt	Electronic
MTHZ-4000	Red Terminal	Black Terminal	0-22v	390-Watt	Electronic
Lionel 1032	U	A	5-16v	90-Watt	Standard
Lionel 1032M	U	A	5-16v	90-Watt	Standard
Lionel 1033	U	A	5-16v	90-Watt	Standard
Lionel 1043	U	A	5-16v	90-Watt	Standard
Lionel 1043M	U	A	5-16v	90-Watt	Standard
Lionel 1044	U	A	5-16v	90-Watt	Standard
Lionel 1053	U	A	8-17v	60-Watt	Standard
Lionel 1063	U	A	8-17v	60-Watt	Standard
All-Trol	Left Terminal	Right Terminal	0-24v	300-Watt	Electronic
Dallee Hostler	Left Terminal	Right Terminal			Electronic
Lionel LW	A	U	8-18v	75-Watt	Standard
Lionel KW	A or B	U	6-20v	190-Watt	Standard
Lionel MW	Outside Track Terminal	Inside Track Terminal	5-16v	50V.A.	Electronic
Lionel RS-1	Red Terminal	Black Terminal	0-18v	50V.A.	Electronic
Lionel RW	U	A	9-19v	110-Watt	Standard
Lionel SW	U	A	Unknown	130-Watt	Standard
Lionel TW	U	A	8-18v	175-Watt	Standard
Lionel ZW	A, B, C or D	U	8-20v	275-Watt	Standard
Lionel Post-War Celebration Series ZW	A, B, C or D	Common	0-20v	135/190 Watt	Electronic

2-8-0 Steam Locomotive Engine Parts

Name and Number	Part #
1.) Stanchion(black) (plastic)(3.0mm long)	FB-1200242
2.) Handrail(nickel)(boiler)	FB-1200099
3.) Bell (nickel)	FB-1200101
4.) Shell (black)(CNW)(# 1761)	FB-1200239
5.) Lens (green)(marker)	FA-1230025
6.) Lens (clear)(headlight)	FA-1230022
7.) Number board (black)	FB-1200178
8.) Smoke unit (7.0x8.0x2.0x3.7mm brass cup)(7.5mm longposts) (Proto-Sound 2.0® & Loco Sound™)	AA-0000029
9.) Bulb (clear)(headlight) (6V)(small globe)(screw base)	CA-0000038
10.) Bracket (black) (smoke unit / headlight)	IH-0000085
11.) Screw (4/40x6.0mm)(roundhead)	IA-0000003
12.) Crosshead (nickel) (38.8mm long)	EC-1250016
13.) Drive rod (nickel)	EC-1250015
14.) Drive block (black)(4 axle)	DF-1200018
15.) Bolt (nickel) (hexhead 5.0mm)(M3x9.5mm long) (4.0x2.5mm shoulder)	IA-0000253
16.) Side rod(nickel) (116.0mm long)(4 holes)	EC-1250017
17.) Traction tires	DE-0000023
18.) Insulator (black) (top)(square)(pick-up)	BD-0000026
19.) Screw (nickel) (M3x6.0mm)(roundhead)	IA-0000015
20.) Wire strap(white) (metal)(tab bends over wires)	IH-0000103
21.) Tach board (no spacer between board and optical sensor) (has a tiny resistor on backside of tach board)	AG-0000048
22.) Motor (RS-365SH) (8.0x21.0mm gear shaft)(13.0mm gear threads) (9.0x30.0mm white flywheel w/ black stripes) (tach board mounting strap)	BE-0000076
23.) Screw (6/32x8.0mm)(roundhead)	IA-0000050
24.) Motor mount (black)	BI-0000034
25.) Screw (yellow Zink) (M2.5x6.0mm)(roundheadw/ lockwasher)	IA-0000089

26.) Wire nut(yellow)	BI-4500003
27.) PC board(green) (w/ 10pinfemaleplug)	AG-0000039
28.) Draw bar (black) (67.5mm long)	FB-1200079
29.) Spring (6.5x10.0mm)(w/0.6mmthick wire)	IE-0000061
30.) Screw (4/40x6.0mm)(washer head)	IA-0000028
31.) Nut (nickel)(2.5x5.0x10.0mm)	IC-0000005
32.) Insulator (black) (pick-up)(bottom)(flat)(square)	BD-0000024
33.) Pick-up (8.0x11.0mm roller)(24.0mm long)	BD-0000050
34.) Bolt (nickel) (M3x9.5mm long)(4.0x2.5mm shoulder) (5.0mm hex head)	IA-0000253
35.) Truck (lead)(single axle)	DA-1230013
36.) E-clip (2.5x6.0x0.5mm)	IF-0000004
37.) Washer (3.0x7.0x0.4mm)	ID-0000028
38.) Spring (6.5x11.0mm)(w/0.4mmthick wire)	IE-0000007
39.) Pin (3.0x9.0mm)(flathead)(1 e-clip groove)	IG-0000007
40.) Pivot plate(nickel) (for lead truck)	IH-0000021
41.) Bracket (black) (metal)(18.6x32.4x40.5mm)(T shaped)	IH-0000211
42.) Ferrite bead	AI-0000030
43.) Capacitor(blue)(.01 uF) (16.0x2.0mm)(w/ 2 wires)	AI-0000031
44.) Steam dome (black)	FB-1200247
45.) Sand dome (black)	FB-1200246
46.) Washer (black) (3.0x6.0x0.4mm)(fiber)	ID-0000040

2-8-0 Steam Locomotive Engine Parts

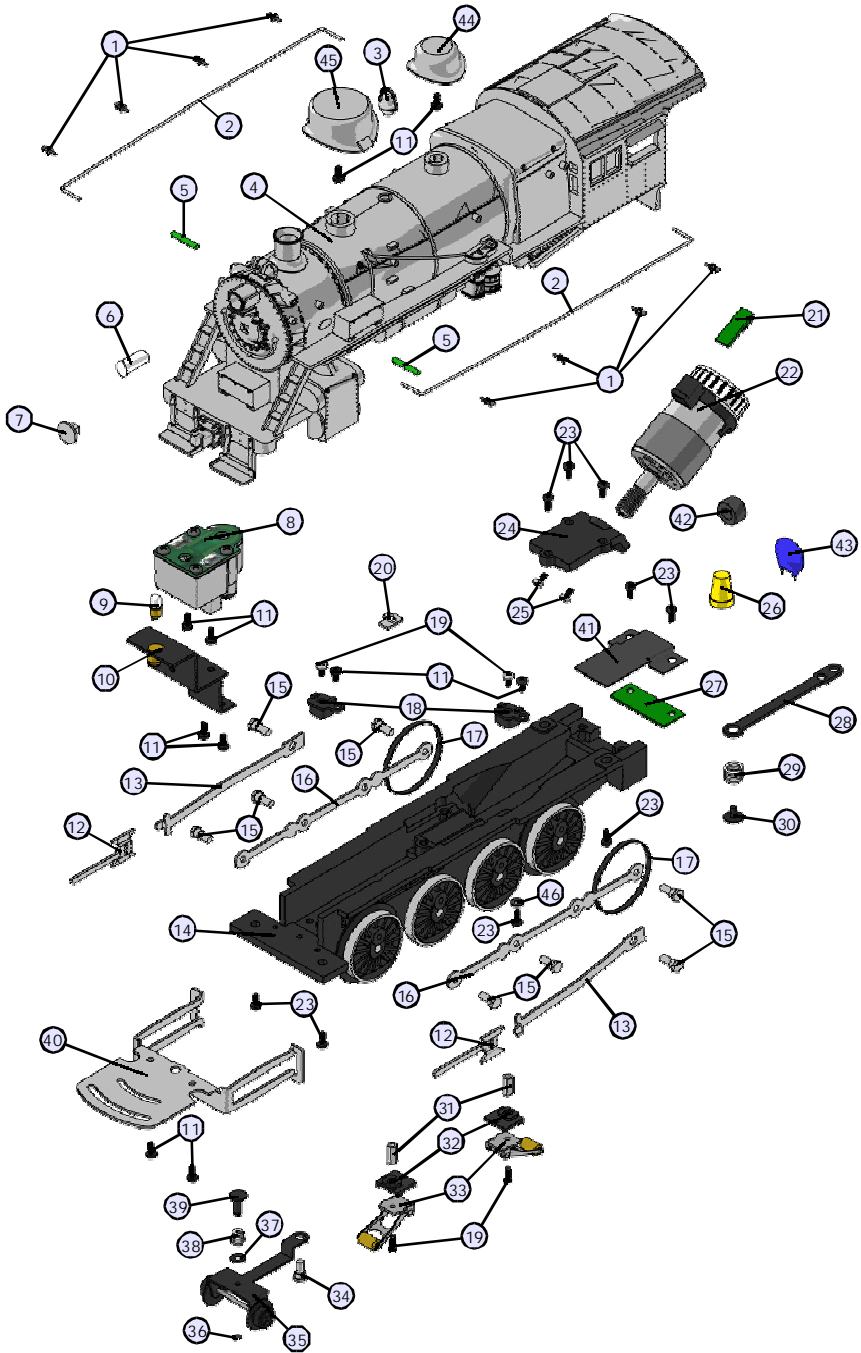

2-8-0 Steam Engine Tender Parts

Name and Number	Part #
1.) Shell (black) (tender)(plastic)(CNW)(# 1761)	GA-1200094
2.) Board (Loco-Sound™)(steam/turbine)	AE-0000003
3.) Screw (4/40x8.0mm)(roundhead)	IA-0000011
4.) Insulator (white) (washer)(3.0x6.0x3.0mm)(plastic)	ID-0000025
5.) Insulator (clear) (13.0x19.0x0.1mm)(single hole)	ID-0000024
6.) Screw (M3x4.0mm)(roundhead)	IA-0000010
7.) Screw (M3x6.0mm)(roundhead)	IA-0000016
8.) Wire nut (yellow)	BI-4500003
9.) Speaker cone (black) (44.0x48.3x37.0mm)(plastic)(2 screw holetabs)	BF-0000020
10.) Speaker (Cuistack)(GF0501, 8 ohms, 0.25 watt)	BF-0000015
11.) Wire harness (black)	BC-1200103
12.) Screw (M2x4.0mm)(roundhead)	IA-0000058
13.) Switch (small)	BB-0000009
14.) Screw (4/40x6.0mm)(roundhead)	IA-0000003
15.) Bracket (Aluminum) (for Loco-Sound™ board) (14.0x76.0x24.7mm)(5.0mm step)	IH-0000212
16.) Screw (M3x8.0mm)(roundhead)	IA-0000035
17.) Volume pot (small) (blue w/ green board)	BI-0000040
18.) Spacer (black) (3.0x6.0x4.0mm)(plastic)	ID-0000071
19.) Chassis (black) (58.0x175.0mm)(has new hole for battery jack)	GB-1200047
20.) Screw (M3x16.0mm)(washer head)(self-drilling threads)	IA-0000025
21.) Fbar	IG-0000001
22.) Coupler (black) (mechanical)(51.5mm long)	DD-0000039
23.) Armature(black) (45.0mm long)	DD-0000040
24.) Spring (6.5x11.0mm)(w/0.4mm thick wire)	IE-0000007

25.) Washer (black)(plastic) (4.6x8.6x2.0mm)(inside 7.0x1.0mm)(cup shaped)	ID-0000060
26.) E-clip (3.0x8.0x0.5mm)	IF-0000002
27.) Truck (black) (tender)(2 axle)	DA-1250012
28.) Screw (6/32x6.0mm)(washer head)	IA-0000214
29.) Gasket (black) (speackerring)(43.8x49.8x3.0mm)(foam)	IB-0000009
NS.) Wire harness (12 pin black maleplug)	BC-1200104

2-8-0 Steam Engine Tender Parts

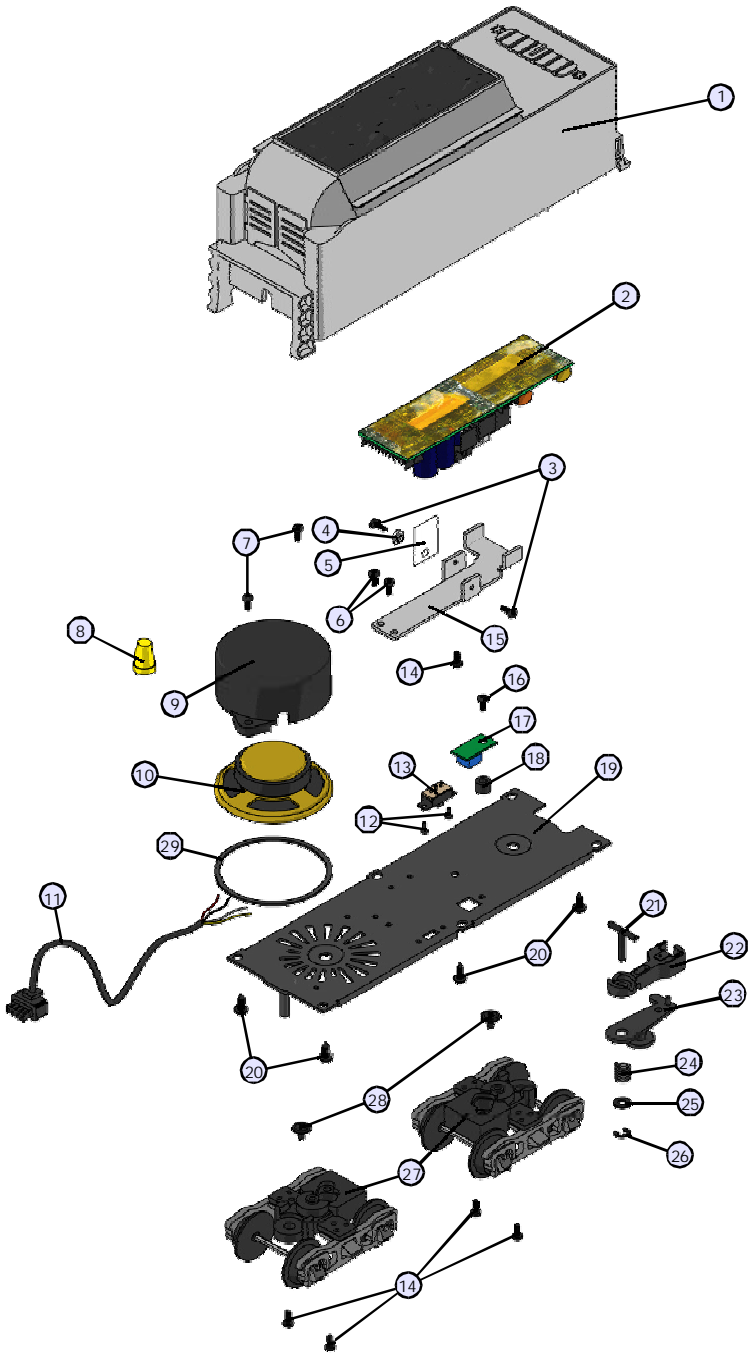

Service & Warranty Information

How to Get Service Under the Terms of the Limited One-Year Warranty

For warranty repair, follow the instructions below to obtain warranty service.

First, e-mail, write, call or fax an Authorized M.T.H. Service Center in your area or M.T.H. Electric Trains to obtain Repair Authorization. You can find the list of Authorized Service Centers on the M.T.H. website, www.mth-railking.com. Authorized Service Centers are required only to make warranty repair on items sold from that store; all other repairs may or may not be done at the store's own discretion. Otherwise, contact M.T.H. (fill out the Service Contact form in the Service Section of www.mth-railking.com; send US mail to the address listed below; tel: 410-381-2580; fax: 410-423-0009), stating when the item was purchased and describing the problem. If you contact M.T.H., you will be given a return authorization number to assure that your merchandise will be properly handled upon its receipt.

CAUTION: Make sure the product is packed in its original factory packaging including its foam and plastic wrapping material also to prevent damage to the merchandise. The shipment must be prepaid and we recommend that it be insured. *A cover letter including your name, address, daytime phone number, e-mail address (if available), Return Authorization number, a copy of your sales receipt and a full description of the problem must be included to facilitate the repairs. Please include the description regardless of whether you discussed the problem with a service technician when contacting the Service Center or M.T.H. for your Return Authorization.*

Please make sure you have followed the instructions carefully before returning any merchandise for service.

Limited One-Year Warranty

All M.T.H. products purchased from an Authorized M.T.H. Train Merchant are covered by this warranty.

See our website at www.mth-railking.com or call 1-888-640-3700 to identify an Authorized M.T.H. Train Merchant near you.

M.T.H. products are warranted for one year from the date of purchase against defects in material or workmanship, excluding wear items such as light bulbs, pick-up rollers, batteries, smoke unit wicks, and traction tires. We will repair or replace (at our option) the defective part without charge for the parts or labor, if the item is returned to an Authorized M.T.H. Service Center or M.T.H. Electric Trains within one year of the original date of purchase. This warranty does not cover damages caused by improper care, handling, or use. Transportation costs incurred by the customer are not covered under this warranty.

Items sent for repair must be accompanied by a return authorization number, a description of the problem, and a **copy of the original sales receipt from an Authorized M.T.H. Train Merchant**, which gives the date of purchase. If you are sending the item to M.T.H., fill out the Service Contact form in the Service Section of www.mth-railking.com; send US mail to the address listed below; call 410-381-2580, or fax 410-423-0009 to obtain a return authorization number. If you are sending this product to an Authorized Service Center, contact that Center for their return authorization.

This warranty gives you specific legal rights, and you may have other rights that vary from state to state.

Service Department





AUTHORIZED SERVICE CENTER

7020 Columbia Gateway Dr. - Columbia, MD 21046

Information: 410-381-2580 Fax: 410-381-6122

www.mth-railking.com

PARTICIPATING N.A.S.C. RETAILER LIST

CANADA

TOYTRAIN WORKSHOP
CUMBERLAND
613-833-8331

THETRAINROOM
FERGUS
519-787-3280

CALIFORNIA

TINPLATEJUNCTION
OAKLAND
510-444-4780

COLORADO

MIZELTRAINSINC
WESTMINSTER
303-429-4811

CONNECTICUT

NEW ENGLAND HOBBY
SUPPLY
MANCHESTER
860-646-0610

FLORIDA

ROUNDHOUSE SOUTH
PORT O RANGE
386-304-7002

MARYLAND

PLAZAHOBBY
CUMBERLAND
301-729-6424

ENGINEHOUSEHOBBIES
GAITHERSBURG
301-590-0816

CATOCINMOUNTAINTRAINS
& HOBBIES
THURMONT
301-694-8331

MICHIGAN

MICHIGANMODELTRAIN
CENTER
PINCKNEY
734-426-1651

BRASSEURELECTRIC TRAINS
INC.
SAGINAW
989-793-4753

NEWHAMPSHIRE

TREASUREDTOYS
SALEM
603-898-7224

NEWYORK

AURORA RAILS&HOBBIES
EASTAURORA
716-652-5718

OHIO

DAVISELECTRONICS
MILFORD
513-831-6425

RICK'STOYTRAINS
TOLEDO
419-478-0171

PENNSYLVANIA

BUSSINGERTRAINS
AMBLER
215-628-2366

FAIRCHANCEPHARMACY
FAIRCHANCE
724-564-7817

TOBY TYLER'S HOBBY
CENTER
PITTSBURGH
412-653-5030

VIRGINIA

LOCUST GROVE TRAINS
LOCUST GROVE
540-854-8955

DAVISHOBBYSUPPLIES
PORTSMOUTH
757-397-1983

T S G HOBBIES
WARRENTON
540-347-9212

WISCONSIN

SOMMERFELD'S TRAINS
BUTLER
262-783-7797

GRAMPA'S TRAINSHOP
RICE LAKE
715-234-2996



AUTHORIZED SERVICE CENTER

7020 Columbia Gateway Dr. - Columbia, MD 21046

Information: 410-381-2580 Fax: 410-381-6122

www.mth-railking.com

PARTICIPATING A.S.C. RETAILER LIST

CANADA

TOYTRAIN WORKSHOP
CUMBERLAND
613-833-8331

THETRAINROOM
ERGUS
519-787-3280

CREDITVALLEYRAILWAY
COMPANY
STREETSVILLE
905-826-1306

BHTRAINS
TERREBONNE
450-492-0317

ALABAMA
SOUTHERLAND STATION
HUNTSVILLE
256-533-4720

LIL' BOBBY'SHOBBIES
MONTGOMERY
334-277-1715

ARIZONA
ARIZONATRIN DEPOT
MESA
480-833-9486

CALIFORNIA
CENTRALCOAST TRAINS
ATASCADERO
805-466-1391

TRAIN SHACK
BURBANK
818-842-3330

ROUNDHOUSE
NORTH HOLLYWOOD
818-769-0403

DOLLHOUSES TRAINS & MORE
NOVATO
415-883-0388

TINPLATEJUNCTION
OAKLAND
510-444-4780

RON'SWORLD
SANLEMENTE
949-361-5596

TRUCKS&TRAINSHOBBIES
SANTAROSA
707-537-6586

COLORADO
CUSTOM RAILWAYSUPPLY
COLORADOSPRINGS
719-634-4616

CABOOSEHOBBIES
DENVER
303-777-6766

MIZELLTRAINS
WESTMINSTER
303-429-4811

CONNECTICUT
NEWENGLANDHOBBY
SUPPLY

MANCHESTER
860-646-0610

FLORIDA
HOLLYWOOD STATION
HOLLYWOOD
954-921-2700

DEPOTHOBBYSHOP
LAKEWORTH
561-585-1982

READYTOROLL
MIAMI

FRANK'STRAINS&HOBBIES
OLDSMAR
813-855-1041

COLONIAL PHOTO&HOBBY
ORLANDO
407-841-1485

WARRICK CUSTOM HOBBIES
PLANTATION
954-370-0708

ROUNDHOUSE SOUTH
PORT ORANGE
386-304-7002

ILLINOIS
BIKE&CHOOCHOO
CONNECTION
SCHAUMBURG
847-882-7728

INDIANA
Y.O.R.K.TRAINS
MUNSTER
219-838-9999

SAMUELSON'STRAINSHOP
VALPARAISO
219-462-2708

IOWA
CABOOSSETOHOBBIES
CEDARFALLS
800-642-7012

KENTUCKY
L&NTRAINS&THINGS
LOUISVILLE
502-897-9005

LOUISIANA
AMERICA'STRAINYARD
BATONROUGE
225-926-5592

MAINE

WHEELS, WINGS & THINGS
LUDLOW

207-532-6277

MARYLAND

PLAZA HOBBY
CUMBERLAND
301-729-6424

HOBBYTOWN S A
FREDERICK
301-694-7395

ENGINE HOUSE HOBBIES
GAITHERSBURG
301-590-0816

J & B TRAINS
HAGERSTOWN
240-420-4930

THE TRAIN ROOM
HAGERSTOWN
301-745-6681

PURKEY'S TOY TRAINS
SYKESVILLE
410-549-6061

CAT OCTIN MOUNTAIN TRAINS
& HOBBIES
THURMONT
301-694-8331

MASSACHUSETTS

NORTHEAST TRAINS
PEABODY
978-532-1615

EAST BAY HOBBIES
SEEKONK
508-336-5573

MICHIGAN

MICHIGAN MODEL TRAIN
CENTER
PINCKNEY
734-426-1651

BRASSEUR ELECTRIC TRAINS
INC.
SAGINAW
989-793-4753

MISSOURI

SWITCHSTAND
SAINT LOUIS
314-781-4458

MARK TWAIN HOBBY CENTER
ST. LOUIS
636-946-2816

NEVADA

RENO RAILS
RENO
775-337-6669

NEW HAMPSHIRE

RAILROAD SPECIALTIES
NASHUA

TREASURED TOYS

SALEM
603-898-7224

NEW JERSEY

COUNTRY AND STUFF
ANDOVER
973-786-7086

COLUMBUSTRAINSTATION

COLUMBUS
609-518-1800

ATLANTIC RAILS
HAMMONTON
609-567-8490

GRAND CENTRAL STATION
KEARNY

201-955-6200

J & B TRAINS, INC.

MAPLESHADE
856-414-0092

HOBBY SHOP

MATAWAN
732-583-0505

HOBBYMASTERS, INC

RED BANK
732-842-6020

RIDGEFIELD HOBBY

RIDGEFIELD
201-943-2636

TOM'S MODEL TRAINS

SCOTCH PLAINS
908-322-6122

TRAINS & THINGS

TRENTON
609-883-8790

COAST TRAINS AND

COLLECTIBLES
WALL

732-556-9005

HOLLY BEACH TRAIN DEPOT

WILDWOOD
609-522-2379

NEW YORK**AURORA RAILS & HOBBIES**

EAST AURORA
716-652-5718

NASSAU HOBBY CENTER, INC.

FREEPORT
516-378-9594

HOBBY WORLD

MONTICELLO
845-794-8770

CITY DEPOT, INC.

NEW HAMPTON
845-374-3010

SCAG'S ELECTRIC TRAINS

STATEN ISLAND

AMERICAN STORE

TIVOLI
845-757-4246

KROSS HARDWARE

WEST B ABYLON
631-669-3069

NORTH CAROLINA

THE ROUNDHOUSE &
BACKSHOP
CARY

919-465-0810

TRAIN SLTD.

CHARLOTTE
704-566-9070

DRY BRIDGE STATION

MOUNTAIRY
336-786-9811

THE FREIGHT YARD

SMITHFIELD
919-934-6229

TRAIN LOFT

WINSTON-SALEM
336-760-9817

OHIO**GLEN'S TRAIN SHOP**

AKRON
330-253-6527

E & S TRAINS

AKRON
330-745-0785

T & K HOBBY SHOP

BRIDGEPORT
740-633-6607

PARMA HOBBY

CLEVELAND
216-741-6440

SANDY'S HOBBY'S &

COLLECTIBLES

ELYRIA

440-365-9999

HUDSON TOY, TRAIN &

HOBBY

HUDSON

330-653-2997

CLEARVIEW TRAIN & HOBBY

LORAIN

440-277-4488

DIXIE UNION STATION

MASON

513-459-0460

DAVIS ELECTRONICS

MILFORD

513-831-6425

TRAINS-N-THINGS
NORTH CANTON
330-499-1666

GRAND PACIFIC JUNCTION
OLMSTEAD FALLS
440-235-4777

RICK'S TOY TRAINS
TOLEDO
419-478-0171

ERIE RAILWAY DEPOT
TROY
937-440-9972

PENNSYLVANIA

AMERICAN HOBBY CENTER
ALIQUIPPA
724-378-3930

ALLEN TOWN TOY TRAIN
SERVICE
ALLEN TOWN
610-821-0740

ON THE RIGHT TRACK
ALTOONA
814-942-4345

BUSSINGER TRAINS
AMBLER
215-628-2366

JIM'S HOBBY SERVICE
BERWICK
570-759-2695

YE OLDE TRAIN & CHRISTMAS
SHOPPE
BOYERTOWN
610-369-0755

NICHOLAS SMITH
BROOMALL
610-353-8585

CHARLEROI SWEEPER
CENTER
CHARLEROI
724-483-3397

CRANBERRY HOBBY DEPOT
CRANBERRY TWP
724-776-3640

FAIR CHANCE PHARMACY
FAIR CHANCE
724-564-7817

TOY TRAIN STATION
FEASTERVILLE TREV
215-322-5182

THE CABOOSE
LEHIGHTON
570-386-5352

HOBBY CITY
MCMURRAY
724-942-2557

THE STATION
NEW CUMBERLAND
717-774-7096

FRYER'S STORE
ORWIGSBURG
570-366-2258

CHESTNUT TOY BOX
PHILADELPHIA
215-545-0455

TOBY TYLER'S HOBBY
CENTER
PITTSBURGH
412-653-5030

WILCOX GREENHOUSE &
NURSERY
TITUSVILLE
814-827-3823

EASTERN DEPOT
TROY
570-297-1975

J&R RAILROAD CROSSING
TURTLE CREEK
412-824-6009

TRAINS R FUN
LEESBURG
703-779-8600

SOUTH CAROLINA

EMERALD TRAIN & HOBBY
GREENWOOD
864-223-2247

TENNESSEE

MODEL RAILROAD & HOBBY
SHOP
MEMPHIS
901-384-6500

TEXAS

HOBBY TIME
AMARILLO
806-352-9660

RIVERVIEW TRAINS
ANGLETON
979-848-3895

GREAT TRAINS & HOBBIES
LONGVIEW
903-757-2720

VIRGINIA

LEESBURGH HOBBIES
LEESBURG
703-779-8600

LOCUST GROVE TRAINS
LOCUST GROVE
540-854-8955

TRAIN DEPOT
MANASSAS
703-335-2216

CHESTERFIELD HOBBIES
MIDLOTHIAN
804-379-9091

DAVIS HOBBY SUPPLIES
PORTSMOUTH
757-397-1983

TOY TRAIN CENTER
RICHMOND
804-288-4475

NUTBUSH EXPRESS
VICTORIA
434-696-1902

T S G H HOBBIES
WARRENTON
540-347-9212

NORGE STATION
WILLIAMSBURG
757-564-7623

WASHINGTON

EASTSIDE TRAINS
KIRKLAND
425-828-4098

WEST VIRGINIA

PATRICK'S TRAINS
WHEELING
304-232-0714

WISCONSIN

WOODCRAFTERS SHOP
BURLINGTON
262-763-5239

SOMMERFELD'S TRAINS
BUTLER
262-783-7797

HOBBY OUTLET
FOND DULAC
920-924-3770

G B T V & TRAINS
GREEN BAY
920-496-9697

GRAMPA'S TRAIN SHOP
RICELAKE
715-234-2996

THE TRAIN STORE
WAUKESHA
262-650-6675