

*RAILKING*  
**READY-TO-RUN™**  
THE COMPLETE SOLUTION

[www.railking.com](http://www.railking.com)

# NW-2 Switcher FDNY Set®

## Operation Manual



Thank you for purchasing this RailKing product.  
**PLEASE READ BEFORE USE AND SAVE**

# Table of Contents

<b>SetUp Checklist...</b>	<b>3</b>
<b>Getting Started...</b>	<b>4</b>
Assembling Real Trax	4
Connecting the Transformer	4
Lubricating the Engine	5
Coupling the Engine and Cars	5
Remote Control	5
<b>Basic Operation</b>	<b>6</b>
Operation Buttons	6
Speed Control	7
Direction Lock	7
Proto-Cast and Proto-Dispatch	7
Manual Volume Control	9
<b>Maintenance.....</b>	<b>10</b>
Care of Remote Control	10
Lubrication and Greasing Instructions	10
Cleaning the Wheels, Tires and Track	11
Locomotive Traction Tire Replacement	11
Locomotive Light Bulb Replacement	12
Caboose Light Bulb Replacement	12
<b>RailWare Interactive CDROM</b>	<b>13</b>
<b>Troubleshooting</b>	<b>14</b>
<b>Compatibility</b>	<b>15</b>
<b>Transformer Compatibility Chart.....</b>	<b>15</b>
<b>Exploded View Parts</b>	<b>16</b>
<b>Service and Warranty Information</b>	<b>20</b>

## CAUTION: ELECTRICALLY OPERATED PRODUCT:

Not recommended for children under 10 years of age. M.T.H. recommends adult supervision with children ages 10-16. As with all electric products, precautions should be observed during handling and use to reduce the risk of electric shock.

**WARNING:** When using electrical products, basic safety precautions should be observed, including the following: Read this manual thoroughly before using this device.

- M.T.H. recommends that all users and persons supervising use examine the hobby transformer and other electronic equipment periodically for conditions that may result in the risk of fire, electric shock, or injury to persons, such as damage to the primary cord, plug blades, housing, output jacks or other parts. In the event such condition exist, the train set should not be used until properly repaired.
- Do not operate your layout unattended. Obstructed accessories or stalled trains may overheat, resulting in damage to your layout.
- This train set is intended for indoor use. Do not use if water is present. Serious injury or fatality may result.
- Do not operate the hobby transformer with damaged cord, plug, switches, buttons or case.
- The transformer was designed to operate on regular US household current (120 volt, 50-60 Hertz). Do not connect to any other source of power.
- To avoid the risk of electrical shock, do not disassemble the transformer unit. There are no user-serviceable parts inside. If the unit is damaged contact M.T.H. Service for instructions.
- The transformer is equipped with an internal circuit protector. If the circuit protector trips, unplug the power cord from the electrical wall outlet, check your layout for any short circuits. The circuit breaker will reset automatically when the short is removed from the circuit.
- Unplug the transformer from the electrical wall outlet when not in use.
- Do not use this transformer for other than its intended purpose.

## Transformer Ratings:

Input: 120VAC, 60Hz Only, Output: 21VAC, 3.75A 78VA

# Set Up Checklist

- Assemble RealTrax®
- Connect the transformer
- Lubricate the engine
- Place the engine and cars on the track and couple them together
- Position remote lock-on lens
- Apply power to run as described in the Basic Operation section of these instructions.

## Set Includes



Diesel Engine with Loco-Sound™



8-Pieces  
O-31 Curve RealTrax



Lock-On



Track Clips



Box Car



Remote Control



Transformer



Flat Car w/ bulldozer



Caboose

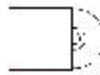

CD-Rom



Video

## Tools Needed

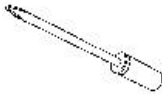

Philips Screwdriver



Pliers



Scissors



Cotton Swab or Rag



Rail King Maintenance Kit  
Light, Household Oil, and Bearing Grease

## Optional Equipment



Microphone w/ 1/8" Plug



1/8" Male to Male Plug



Cassette Player

**You can obtain replacement parts and replacement instructions from the M.T.H. Parts Department**

e-mail: [parts@mth-railking.com](mailto:parts@mth-railking.com)

phone: 410-381-2580

mail: 7020 Columbia Gateway Drive, Columbia MD 21046-1532

# Getting Started

## Assembling RealTrax<sup>®</sup>

The quick connectors and built-in road bed allow you to set up RealTrax anywhere, including carpeted surfaces.

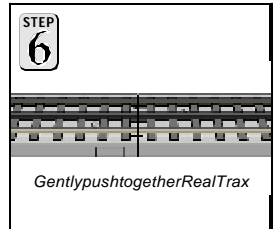
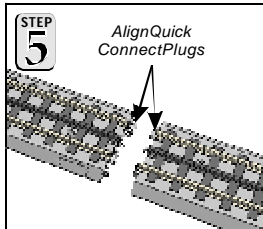
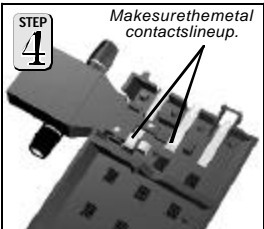
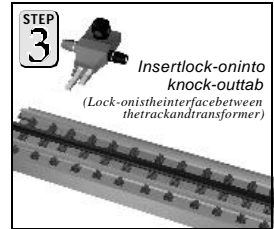
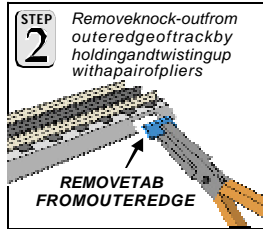
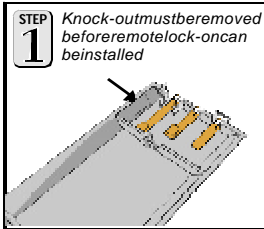

### Connecting TrackClips

If you prefer not to screw your track to the table for a permanent layout, use the enclosed track clips on adjoining curved RealTrax sections to secure them in place.

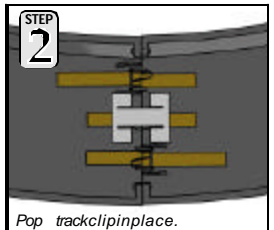
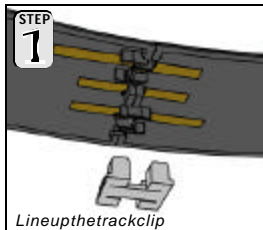

### Connecting the Transformer

The 75-watt power supply included with this set provides an easy-to-use, safe power source for AC-powered trains and accessories.

- Plug the wire from the transformer into the remote lock-on's center port, then plug the transformer into the wall outlet.
- Unplug when not in use.

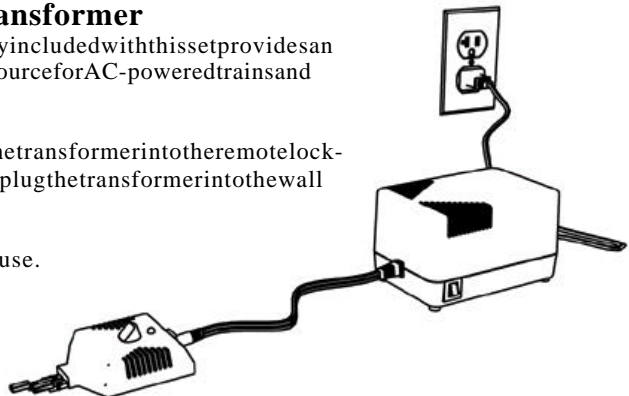



# Lubricating and Greasing the Engine

Lubricate all exposed moving parts before operating using a multi-purpose, plastic-compatible oil (available with M.T.H.'s Maintenance Kit, sold separately) or a light household oil. Follow the lubrication points.

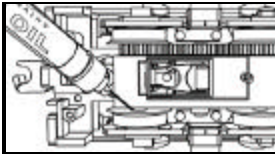

Lubricate Axles

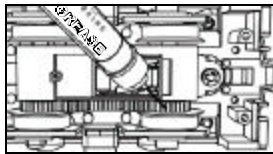

Grease Gears

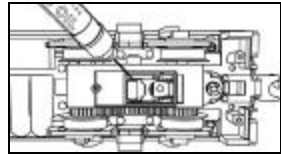

Lubricate Pick-Up Rollers  
(Do Not Lubricate the Flat Part of Pick-Up Rollers)

# Coupling the Engine and Cars

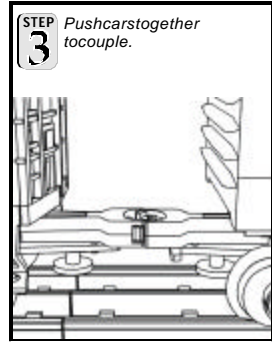
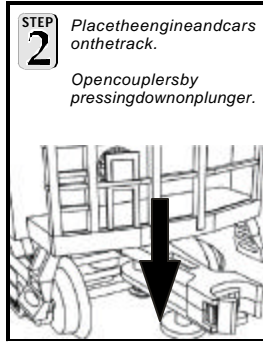
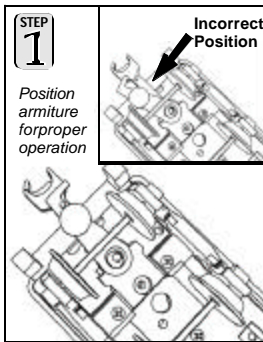

# Remote Control

The remote and lock-on are redesigned for use with moderate power supplies such as the one included with this set. It is compatible with virtually any manufacturer's engines.

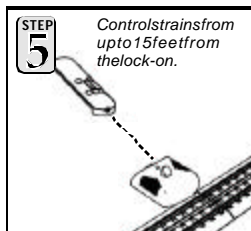
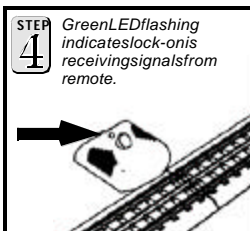
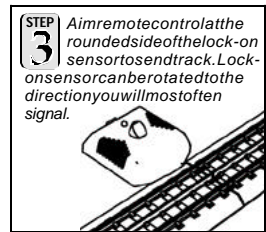
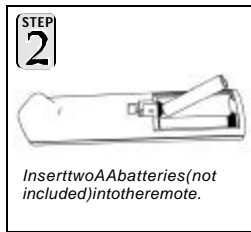
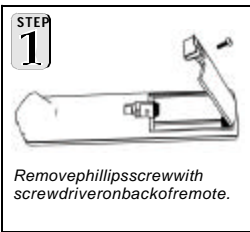

**Note:** The RailKing® Remote Control and Remote Lock-on will not operate engines equipped with pre-1997 versions of Proto-Sound® or with Proto-One,™ Proto-Plus,™ Proto-Deluxe,™ aftermarket systems.

# Basic Operation

## Operation Buttons

**Throttle Up** Throttle up the power to your track by pressing the top end of the Throttle Control Rocker Switch firmly for about 5 seconds, until the engine's headlight and lighted cars burn bright. Then put the engine in motion by firmly pressing the Direction button (hold it for approximately 1 second) on your remote once. If the engine does not begin to move as soon as you firmly press the Direction button, you may not have sent enough voltage to the track to make the train move. Press the throttle up for a few more seconds until the train begins to move.

To increase or decrease track voltage, and therefore train speed, press the throttle control rockerswitch. Pressing the top end of the throttle will increase voltage and speed. Pressing the bottom end of the throttle will decrease voltage and speed.

The engine will maintain the speed you set after you release the throttle until you press it again to change the voltage and speed.

**Bell** - To sound the bell, firmly press and release the Bell button. To turn the bell off, press and release the Bell button again. The bell will continue to ring from the time you turn it on until you press and release the button again to turn it off.

**Emergency Stop** Press the Emergency Stop button and all trains on the track controlled by the remote will stop until you reapply voltage. This is an easy way to shut down your trains at the end of a session or to stop suddenly if the train's path becomes obstructed.

**CAUTION:** *Do not mix old and new batteries. Do not mix alkaline, standard (carbon-zinc), or rechargeable (nickel-cadmium) batteries.*

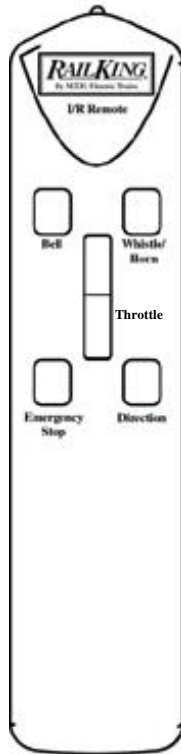

**Horn/Whistle** - To sound the horn, firmly press the Horn/Whistle button. The horn will sound for as long as you continue to depress the button. It will stop when you release the button.

**Direction** Your train is programmed to start in neutral. The train will always cycle neutral-forward-neutral-reverse with each press and release of the direction button. The engine is programmed to restart in neutral each time the track voltage is turned off for 25 seconds or more.

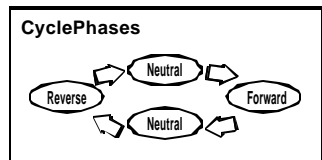

## Speed Control

M.T.H. engines equipped with Loco-Sound have speed control capabilities that allow the engine to maintain a constant speed up and down grades and around curves, much like an automobile cruise control. You can add or drop cars on the run, and the engine will maintain the speed you set.

The engine is programmed to start with the speed control feature activated, you can opt to turn it off. This means the engine's speed will fall as it labors up a hill and increase as it travels downward. It is also affected by the addition or releasing of cars while on the run. Because the engine will run more slowly at a given throttle voltage when speed control is on than when it is off, you should adjust the throttle to a lower power level for operation with speed control off to avoid high-speed derailments.

**To turn speed control on and off**, put the engine in neutral, then quickly tap the transformer's Horn button one time then quickly tap the Bell button two times, allowing approximately 1/2 second to lapse between each quick button press. Repeat the 1 horn, 2 bells code to return to the other condition. **You will want to do this during the initial neutral upon start-up if you ever couple this engine to another engine that is not equipped with speed control to avoid derailment and damaging the motors in either engine.** Each time you shut down the engine completely, it will automatically turn speed control on.

Timing Chart				
Press Horn Short & Firm	1/2 Sec. Pause	Press Bell Short & Firm	1/2 Sec. Pause	Press Bell Short & Firm
Total Time Lapse: 1 1/2 Seconds				



Place Engine into Neutral



Speed Control Repeat to Return to Normal Condition

## Direction Lock

You can lock your engine into a direction (forward, neutral, or reverse) so that it will not change directions. To do this, put the engine into the direction you want or into neutral, to lock it into neutral, run it at a very slow crawl (as slowly as it will move without halting), and quickly but firmly tap the Horn button once followed by three quick taps of the Bell button, allowing approximately 1/2 second to lapse between each quick button press. The engine will not change direction (including going into neutral) until you repeat the 1 horn, 3 bells code to return the engine to its normal condition, even if the engine is kept without power for extended periods of time.

Place Engine into Desired Direction



Direction Lock Repeat to Return to Normal Condition

## Proto-Cast and Proto-Dispatch:

When used with the remote lock-on included in this set, Loco-Sound-equipped engines gain Proto-Cast™ and Proto-Dispatch™ features.

**Proto-Cast:** Allows you to play audio recording through your engine's speakers. You must supply the audio source (a small portable CD/tape player is sufficient) and a male-to-male minicable (1/8" plug, like that used for the headset with a portable CD/tape player) to connect your audio source to the remote lock-on.



### To use Proto-Cast

- Plug the mini-cable *first* into your audio source (usually into the headphone jack)
- Plug Cable into the "Audio" port on the right side of the remote lock-on.
- Adjust the volume. If engine sounds keep breaking through the recorded sounds, increase the volume on the audio source.

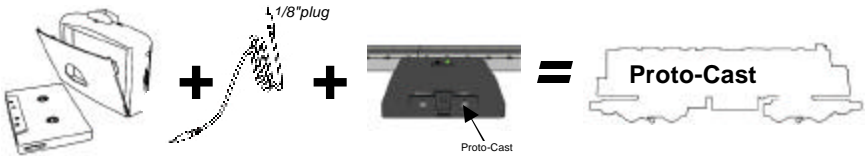

**Proto-Dispatch:** This feature allows you to broadcast your own voice through your engine's speakers. You must supply the microphone and a minicable (1/8" plug, like that used for the headset with a portable CD/tape player) to connect your microphone to the remote lock-on.



### To use Proto-Dispatch

- Mini-cable attached to the microphone must be an 1/8" plug.
- Plug the "Mic" into the proto-dispatch port on the left side of the remote lock-on and speak into the microphone.



When these features are in use, the locomotive's own sounds (engine sounds and bells, whistles, and horns) will be muted so that only the sounds you broadcast will be heard. Because these two features are voice activated, there will be a several second delay after you stop speaking into the microphone or turn off the audio source before the engine sounds resume. To stop using the feature and return to normal operation, unplug the cable from the lock-on jack.

If using parallel tracks with multiple Loco-Sound-equipped engines, Proto-Cast and Proto-Dispatch transmissions from one track may be picked up by the other nearby engines.

If you experience popping and interference when using Proto-Castor Proto-Dispatch, try cleaning the track with denatured alcohol as described in the "Cleaning the Wheels, Tires and Track" section of this booklet.

**Note:** M.T.H. does not recommend using Proto-Cast and Proto-Dispatch at the same time.

## Manual Volume Control

To adjust the volume of all sounds made by this engine, turn the master volume control knob located under the engine clockwise to increase the volume and counter-clockwise to decrease the volume.

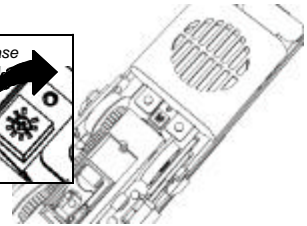
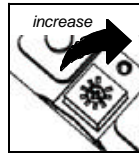

# Maintenance

## Care of the Remote Control

To ensure trouble-free operation:

- Do not drop the remote. It can damage the delicate electronics inside.
- Remove batteries before storing for extended periods.
- Any attempt by anyone other than an authorized M.T.H. repair person to open and repair the handheld transmitter or lock-on may result in damage and the loss of warranty protection.
- If your train responds inconsistently, replace old batteries with fresh ones. Do not mix old and new batteries.

## Lubrication and Greasing Instructions

The engine should be oiled and greased in order to run properly.

Regularly lubricate all axles and linkage components and pick-up rollers to prevent squeaking. Use light household oil, such as that found in M.T.H.'s maintenance kit. Do not overoil. Use only a drop or two on each pivot point.

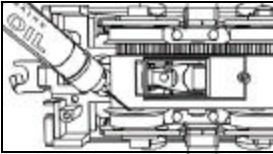

Lubricate Axles

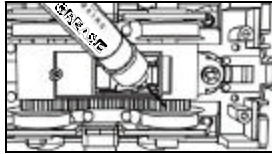

Grease Gears

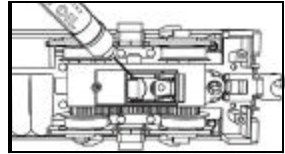

Lubricate Pick-Up Rollers  
(Do Not Lubricate the Flat Part of Pick-Up Rollers)

The locomotive's internal gearing was greased at the factory. Grease engine every 50 hours of use or one year. Use lithium based grease and follow the greasing instructions.

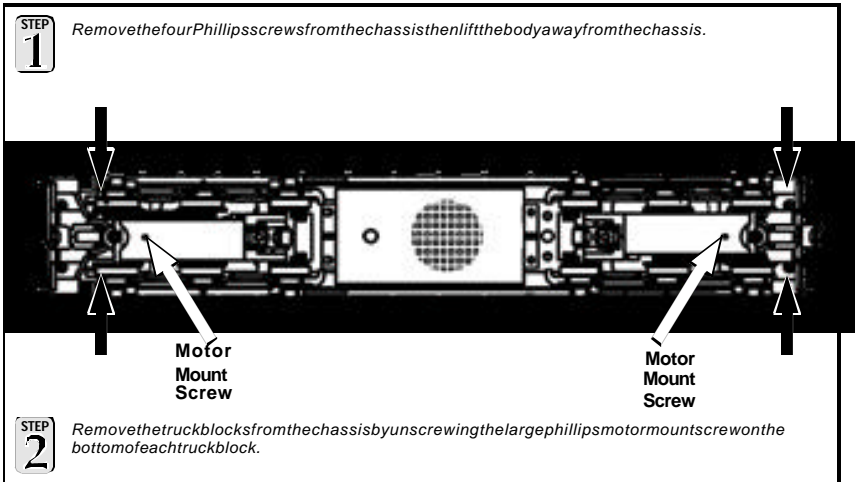

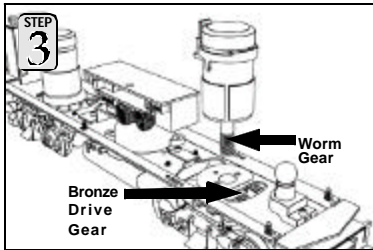

- Once the motor mounts screw has been removed, pull the motor away from the truck block and lightly coat the motor worm gear and bronze drive gear (in the truck block) with grease.
- Reassemble the truck and motor, being careful not to pinch the pickup and ground wires between the truck block and motor mount.
- Repeat the procedure if engine has more than one motor.
- Reassemble the chassis and body, being careful that the wires are not caught between the body and chassis, as this can lead to a short that may damage the electronics beyond repair.

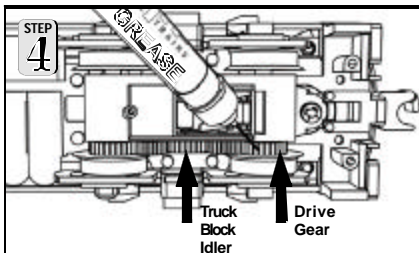

- Lubricate the outside truck block idler and drive gears with grease occasionally.

## Cleaning the Wheels, Tires and Track

Periodically check the locomotive wheels and pickups for dirt and buildup, which can cause poor electrical contact and traction and prematurely wear out the neoprene traction tires. Wheels and tires can be cleaned using denatured (not rubbing) alcohol applied with a cotton swab.



To clean the track, use Rail King Track Cleaning Fluid and a clean rag or denatured (not rubbing) alcohol. Unplug the transformer and wipe the rails of the track, turning the rag frequently to ensure that you are using clean cloth on the rails. Because the manufacturing process leaves a coating on Real Trax center rail, you should clean the rails after the first 30 minutes of use (you may notice an electrical smell during initial use as the coating wears off; this is normal). Thereafter, keep an eye on the track and clean it when it gets dirty to ensure good electrical contact and to lengthen the life of the tires.

## Traction Tire Replacement Instructions

Your locomotive is equipped with two neoprene rubber traction tires on the rear set of flanged drivers. While these tires are extremely durable, you may need to replace them at some point.

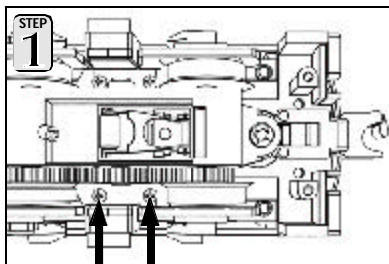

- Remove two screws from below truck side.
- Remove the truck sides from the truck block.
- Make sure the old tire has been completely removed from the groove in the drive wheel, using a razor blade or small flathead screwdriver to pry away any remains.
- Clean the groove using a cotton swab and denatured alcohol.



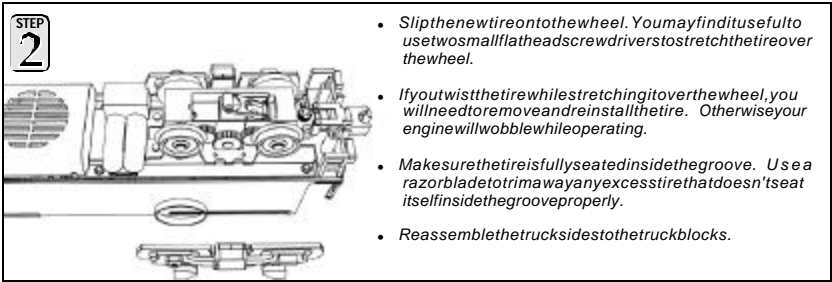

## Locomotive Light Bulb Replacement

Follow the cab removal instructions found in the Greasing Instructions section of this booklet (page 10).

- Rotate the headlight bulb counter-clockwise to remove.

You can obtain replacement bulbs directly from the M. T. H. Parts Department.

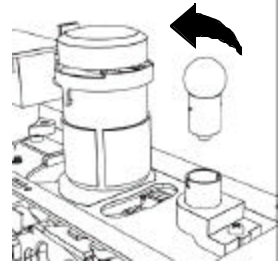

## Caboose Light Bulb Replacement

To replace the interior light bulbs follow these instructions and see the diagrams below.

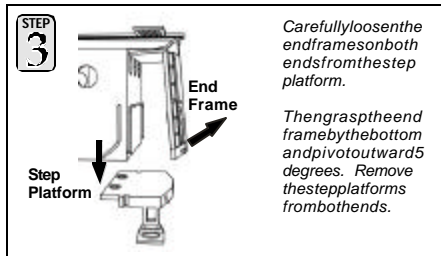
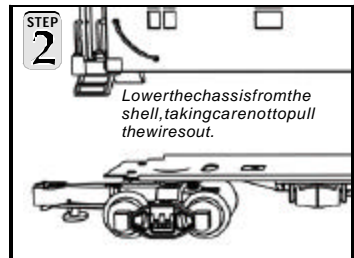
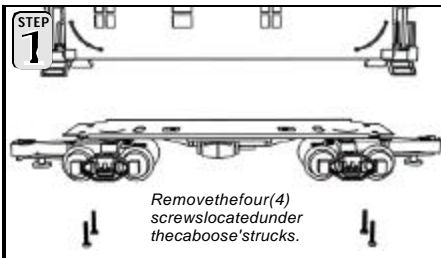



# Quick-Start Video

The included VHS Quick-Start video demonstrates the start-up and basic operation of this set as well as other information about model railroading. You may find it helpful to view the video before operating this set.

# RailWare Interactive CD ROM

M.T.H. provides a free RailWare CD ROM in each Ready-To-Run set. It is full of helpful information on M.T.H. product history, track planning software, a dealer finder, and information and video clips on Loco-Sound and Proto-Sound 2.0. Follow the directions below to use the CD ROM.

Minimum System Requirements: Pentium 100, 16MB RAM, Windows 95 or later, CD ROM drive, Sound Card, display properties set to greater than 256 colors. The CD will not work on a Mac OS unless you run Virtual PC.

# Running RR-Track Software

You may run the RR-Track software directly off of the CD ROM or you may install the software to your hard drive.

1. On the Desktop, click on the icon that says My Computer.
2. Find your CD ROM drive.
3. With the M.T.H. CD ROM in the drive, double click on the icon for the CD ROM drive.
4. Find the folder on the CD ROM entitled INSTALLATION.
5. Choose the folder inside entitled RRTRAXSETUP.
6. Run the file in that folder called SETUP.EXE and follow the directions it provides. The program may ask you for a registration code. If it does type in "M.T.H." and it will run.

Additional track libraries can be obtained directly from RR-Track. See their website for more information [www.rtrack.com](http://www.rtrack.com).

# Installing Adobe Acrobat Software

To read some of the electronic documents included on the CD ROM, you will need to install the Adobe Acrobat Reader® if it is not already on your computer. To install the software:

1. On the Desktop, click on the icon that says My Computer.
2. Find your CD ROM drive.
3. With the MTH CD ROM in the drive, double click on the icon for the CD ROM drive.
4. Find the folder on the CD ROM entitled INSTALLATION.
5. Choose the folder inside entitled ACROBATREADER.

\*If you are running Windows 95, 98 or NT choose the folder 32BIT. Run the file AR32E301.EXE and follow the directions it provides.

If you have problems you cannot resolve by using these directions, contact [custserv@mth-railking.com](mailto:custserv@mth-railking.com) or call 410-381-2580 for further help.

# Troubleshooting Loco-Sound™ Problems

Although Loco-Sound has been designed and engineered for ease of use, you may have some questions during initial operation. The following tables should answer most questions. If your problem cannot be resolved with this table, contact M.T.H. for assistance (e-mail: [service@nth-railking.com](mailto:service@nth-railking.com), telephone: 410-381-2580; fax: 410-423-0009; mail: 7020 Columbia Gateway Drive, Columbia MD 21046-1532).

<b>Starting Up</b>	<b>Remedy</b>
When I first turn the power on, the engine will not begin to run.	This is normal behavior. To prevent accidental high-speed start-ups, Loco-Sound is programmed to start up in neutral any time track power has been turned off for several seconds. See the "Basic Operation" section for more details.
The engine will not start after I press the Direction button.	You may not be sending enough power to the track to power the engine. Press the throttle up for a few more seconds to increase track power.
<b>Horn</b>	<b>Remedy</b>
I can't get the horn to blow when I press the horn button.	You may be pressing the button too quickly. Try pressing the horn button more slowly, taking approximately one full second to fully depress the button.
<b>Bell</b>	<b>Remedy</b>
I can't get the bell to ring when I press the bell button.	You may be pressing the button too quickly. Try pressing the bell button more slowly, taking approximately one full second to fully depress the button.
<b>Lock-out</b>	<b>Remedy</b>
I can't get the engine to run after power up the transformer. It's still with the engine sounds running.	The engine may be locked into the neutral position. Follow the procedure in the "Lock into a Direction" section to <b>unlock the engine's direction</b> .
The engine won't lock into forward, neutral, or reverse.	Engine speed must be below 10 scale mph (approx. 10 volts or less in conventional mode).
<b>Volume</b>	<b>Remedy</b>
The sounds seem distorted, especially when the Horn or Bell is activated.	Loco-Sound volume is set too high. Turn the volume control knob on the bottom of the chassis counter-clockwise to reduce the volume.
No sound.	Volume is set too low, adjust volume control knob on the bottom of the chassis clockwise to increase the volume or check connector to speaker.
<b>Proto-Cast and-Dispatch</b>	<b>Remedy</b>
When I try to play music or my voice through my engine's speakers, there is popping and interference.	Clean the track with denatured alcohol, as described in the "Cleaning the Wheels, Tires, and Track" section of this book.
My Proto-Cast sounds play too quietly or unclearly.	Unplug the cable between the audio source and the remote lock-on. Re-plug it into the audio source first, then into the lock-on, pushing firmly to make sure it is fully installed.
When I try to play Proto-Cast, the engine's sounds keep breaking in on my recording.	Your recording may be playing too quietly to trigger the engine to stop playing its own sound set. Turn up the volume of the audio source you are using.
When I run two Loco-Sound engines on tracks near each other, the Proto-Cast and Dispatch sounds play from both engines, not just from the one connected to the audio source or microphone.	This is normal behavior. Because Loco-Sound uses radio waves to transmit the sound to the engine, other Loco-Sound engines in the same range will also pick up the sound. Try moving one of the sets.

# Compatibility

While this Ready-To-Run set is equipped with everything you need to operate it, the design allows flexibility. The train will operate on any traditional O-31 or larger O Gauge track system, including the RealTrax<sup>®</sup> included with this set or traditional tubular track. It is also compatible with most standard AC transformers, including the hobby transformer packaged with your set.

## Transformer Compatibility and Wiring Chart

Note that many of the operational commands described in these instructions require a bell button, so if you are using a transformer other than the one included in this set and your transformer does not have its own bell button, you should consider adding one to get the full benefit of the system.

Transformer Model	Center Rail	Outside Rail	Min/Max. Voltage	Power Rating	Transformer Type
MTHZ-500	Red Terminal	Black Terminal	0-18v	50-Watt	Electronic
MTHZ-750	Red Terminal	Black Terminal	0-21v	75-Watt	Electronic
MTHZ-4000	Red Terminal	Black Terminal	0-22v	390-Watt	Electronic
Lionel1032	U	A	5-16v	90-Watt	Standard
Lionel1032M	U	A	5-16v	90-Watt	Standard
Lionel1033	U	A	5-16v	90-Watt	Standard
Lionel1043	U	A	5-16v	90-Watt	Standard
Lionel1043M	U	A	5-16v	90-Watt	Standard
Lionel1044	U	A	5-16v	90-Watt	Standard
Lionel1053	U	A	8-17v	60-Watt	Standard
Lionel1063	U	A	8-17v	60-Watt	Standard
All-Trol	Left Terminal	Right Terminal	0-24v	300-Watt	Electronic
Dallee Hostler	Left Terminal	Right Terminal			Electronic
Lionel LW	A	U	8-18v	75-Watt	Standard
Lionel KW	A or B	U	6-20v	190-Watt	Standard
Lionel MW	Outside Track Terminal	Inside Track Terminal	5-16v	50V.A.	Electronic
Lionel RS-1	Red Terminal	Black Terminal	0-18v	50V.A.	Electronic
Lionel RW	U	A	9-19v	110-Watt	Standard
Lionel SW	U	A	Unknown	130-Watt	Standard
Lionel TW	U	A	8-18v	175-Watt	Standard
Lionel ZW	A, B, C or D	U	8-20v	275-Watt	Standard
Lionel Post-War Celebration Series ZW	A, B, C or D	Common	0-20v	135/190 Watt	Electronic

# NW-2 Switcher Diesel Locomotive Engine Parts

<u>Name and Number</u>	<u>Part #</u>
1.) Handrail ( flat black )( end )	FC-2250061
2.) Lens(clear) (reverselight)(flatmounting)	FA-2240002
3.) Shell(black,yellow) ( Caterpillar® )( # 7 6 )	FC-2200269
4.) Airhorns(nickel)(3chime)	FC-2200002
5.) Handrail(flatblack)(right)	FC-2210033
6.) Handrail(flatblack)(left)	FC-2220033
7.) Windows ( clear)	FA-2230004
8.) Rubberband	BI-4500004
9.) Motor(RS-365SH) (7.9x24.0mmwormgearw/13.0mmlongthreads) (9.0x30.0mmblackflywheel)	BE-0000097
10.) Motor(RS-365SH) (7.9x24.0mmwormgearw/13.0mmlongthreads) (9.0x30.0mmwhiteflywheelw/blackstripes) (w/tachboardmount)	BE-0000098
11.) Motormount(black)	BI-0000062
12.) Screw(yellowZinc) (M2.5x6.0mm)(roundhead)(w/lockwasher)	IA-0000089
13.) Screw (M3x14.0mm)(roundhead)(w/lockwasher)	IA-0000012
14.) Bracket(black) (15.0x22.0mmplasticbasew/9.2mmstep) ( forbayonetbulb)	IH-0000267
15.) Screw ( M3x6.0mm)(roundhead)	IA-0000016
16.) Bulb(clear) (6v)(smallglobe)(bayonetbase)	CG-0000024
17.) Speakercone(black) (34.0x37.8x11.0mm)(plastic)(2screwwholetabs) (shavedon2sides)	BF-0000025
18.) Screw (4/40x6.0mm)(roundhead)	IA-0000003
19.) Board ( Loco-Sound™ )	AE-0000002
20.) Tachboard	AG-0000033
21.) Screw (M3x4.0mm)(roundhead)	IA-0000010
22.) Wirenut(yellow)	BI-4500003
23.) Bracket(Aluminum) (14.0x73.0mm)(13.0mm&5.5mm steps ) ( forLoco-Sound™ boards)	IH-0000255
24.) Insulator(clear) (13.0x16.0x0.1mm)(singlehole)	ID-0000024

25.) Insulatorwasher(white) (3.0x6.0x3.0mm)	ID-0000025
26.) Screw (M3x8.0mm)(roundhead)	IA-0000035
27.) Volumepot(small) (bluepotmountedongreenPCboard)	BI-0000040
28.) Spacer(black) (plastic)(3.0x6.0x4.0mm)	ID-0000071
29.) Chassis(black) (forProto-Sound® 2.0&Loco-Sound™w/batteryjack)	DD-2200005
30.) Screw (M3x16.0mm)(washerhead)(self-drillingthreads)	IA-0000025
31.) Screw (4/40x6.0mm)(washerhead)	IA-0000028
32.) Speaker (Cuistack)(GF0501,8ohms,0.25watt)	BF-0000015
33.) Speakerringseal(black) (43.8x49.8x3.0mm)(foam)	IB-0000009
34.) Fuel tank(black) (tappedfor4/40screws)	FC-2200270
35.) Screw (4/40x6.0mm)(flathead)	IA-0000038
36.) Pilot(yellow) (both)(2mountingholes&splitinthemiddle) (Caterpillar®)(#76)	DG-2250043
37.) Truckside(black) (rightfront/leftrear)(trucksidemountfromtop)	DB-2000008
38.) Truckside(black) (leftfront/rightrear)(trucksidemountfromtop)	DB-2000007
39.) Screw(nickel) (M3x6.0mm)(roundhead)	IA-0000015
40.) Insulator(black) (plastic)(pick-up)(top)(square)	BD-0000047
41.) Truck(powerd)(3axle) (2threadedscrewholesformountingpilot) (trucksidemountfromtop)	DA-2000017
42.) Nut(nickel) (2.5x5.0x10.0mm)	IC-0000005
43.) Insulator(black) (pick-up)(bottom)(square)(plastic)	BD-0000001
44.) Pick-up (8.0x11.0mmroller)(24.0mmlong)	BD-0000013
45.) Tractiontire(black)(rubber)	DE-0000018
46.) T-bar (black)(plastic)	IG-0000001
47.) Coupler(black) (mechanical)(44.6mmlong)(T-barmounting)	DD-0000009
48.) Armature(black) (37.8mmlong)(T-barmounting)	DD-0000010

49.) Spring(nickel) (6.5x11.0mm)(w/0.4mmthickwire)	IE-000007
50.) Washer(black)(plastic) (4.6x8.5x0.5mm)(cupshapedforspringtofitin)	ID-000060
51.) E-clip(3.0x8.0x0.5mm)	IF-000002
52.) Lens(clear) ( headlight)(V-shapedmounting)	FA-2230003
NS.) Wireharness (blackmale12pinplug)	BC-2200029
NS.) Wireharness (blackmale7pinplug)	BC-2200030
NS.) Wireharness (blackmale5pinplug)	BC-2200027

# NW-2 Switcher Diesel Locomotive Engine Parts

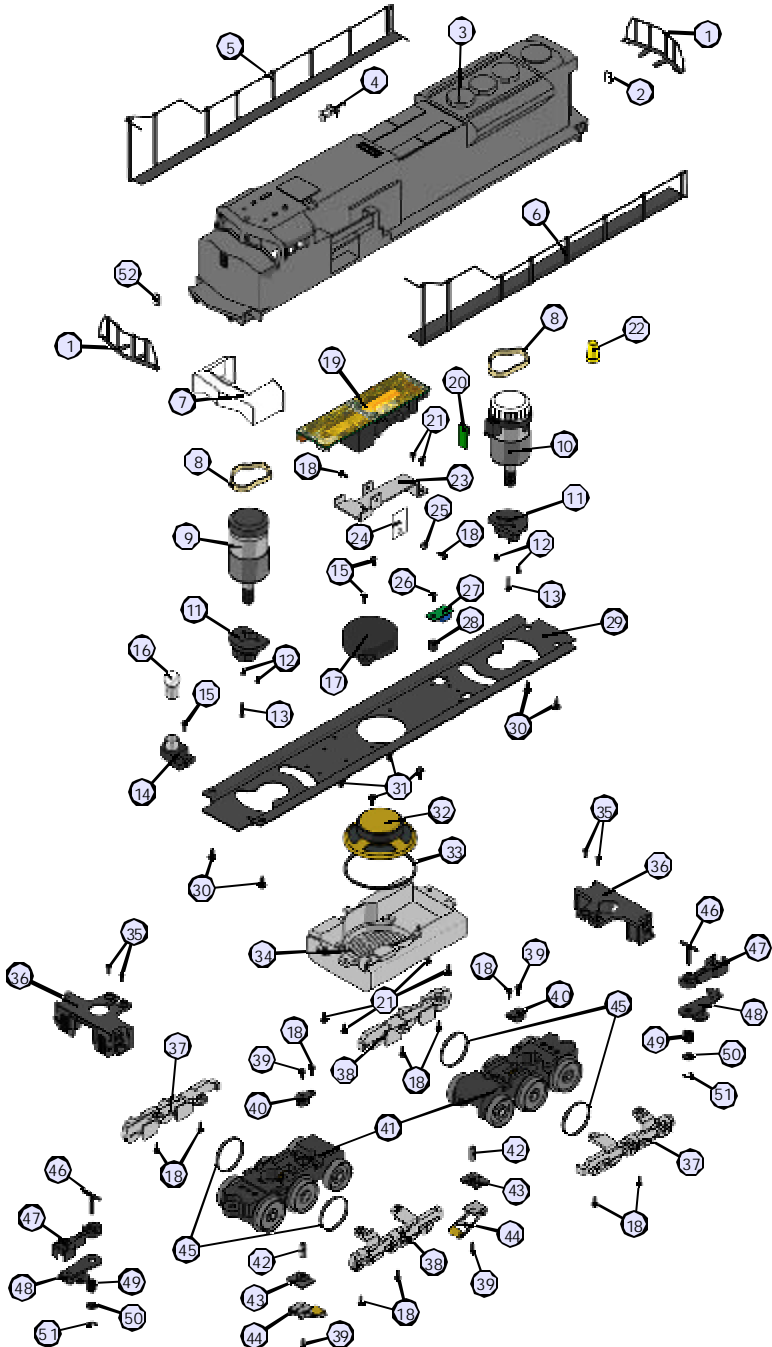

# Service & Warranty Information

## How to Get Service Under the Terms of the Limited One-Year Warranty

For warranty repair, follow the instructions below to obtain warranty service.

First, e-mail, write, call or fax an Authorized M.T.H. Service Center in your area or M.T.H. Electric Trains to obtain Repair Authorization. You can find the list of Authorized Service Centers on the M.T.H. website, [www.mth-railking.com](http://www.mth-railking.com). Authorized Service Centers are required only to make warranty repairs on items sold from that store; all other repairs may or may not be done at the store's own discretion. Otherwise, contact M.T.H. (fill out the Service Contact form in the Service Section of [www.mth-railking.com](http://www.mth-railking.com); send US mail to the address listed below; tel: 410-381-2580; fax: 410-423-0009), stating when the item was purchased and describing the problem. If you contact M.T.H., you will be given a return authorization number to assure that your merchandise will be properly handled upon its receipt.

**CAUTION:** Make sure the product is packed in its original factory packaging including its foam and plastic wrapping material so as to prevent damage to the merchandise. The shipment must be prepaid and we recommend that it be insured. *A cover letter including your name, address, daytime phone number, e-mail address (if available), Return Authorization number, a copy of your sales receipt and a full description of the problem must be included to facilitate the repairs. Please include the description regardless of whether you discussed the problem with a service technician when contacting the Service Center or M.T.H. for your Return Authorization.*

Please make sure you have followed the instructions carefully before returning any merchandise for service.

## Limited One-Year Warranty

All M.T.H. products purchased from an Authorized M.T.H. Train Merchant are covered by this warranty.

See our website at [www.mth-railking.com](http://www.mth-railking.com) or call 1-888-640-3700 to identify an Authorized M.T.H. Train Merchant near you.

M.T.H. products are warranted for one year from the date of purchase against defects in material or workmanship, excluding wear items such as light bulbs, pick-up rollers, batteries, smoke unit wicks, and traction tires. We will repair or replace (at our option) the defective part without charge for the parts or labor, if the item is returned to an Authorized M.T.H. Service Center or M.T.H. Electric Trains within one year of the original date of purchase. This warranty does not cover damage caused by improper care, handling, or use. Transportation costs incurred by the customer are not covered under this warranty.

Items sent for repair must be accompanied by a return authorization number, a description of the problem, and a **copy of the original sales receipt from an Authorized M.T.H. Train Merchant**, which gives the date of purchase. If you are sending the item to M.T.H., fill out the Service Contact form in the Service Section of [www.mth-railking.com](http://www.mth-railking.com); send US mail to the address listed below; call 410-381-2580, or fax 410-423-0009 to obtain a return authorization number. If you are sending this product to an Authorized Service Center, contact that Center for their return authorization.

This warranty gives you specific legal rights, and you may have other rights that vary from state to state.

Service Department







# AUTHORIZED SERVICE CENTER

7020 ColumbiaGateway Dr. - Columbia,MD 21046

Information: 410-381-2580 Fax:410-381-6122

[www.mth-railking.com](http://www.mth-railking.com)

## PARTICIPATING RETAILER LIST

### ALABAMA

SOUTHERLANDSTATION  
HUNTSVILLE  
256-533-4720  
[railway@bellsouth.net](mailto:railway@bellsouth.net)

### ARIZONA

ARIZONATRAINDEPOT  
MESA  
480-833-9486  
[sales@arizonatraindepot.com](mailto:sales@arizonatraindepot.com)  
[www.arizonatraindepot.com/](http://www.arizonatraindepot.com/)

### CALIFORNIA

DOLLHOUSES, TRAINS & MORE  
NOVATO  
415-883-0388  
[kbecker@cmc.net](mailto:kbecker@cmc.net)

TINPLATEJUNCTION  
OAKLAND

510-444-4780  
[TOYTRAINS@email.msn.com](mailto:TOYTRAINS@email.msn.com)

### COLORADO

MIZELL TRAINS Inc  
WESTMINSTER  
303-429-4811  
[mizelltrains@cs.com](mailto:mizelltrains@cs.com)  
[www.mizelltrains.com](http://www.mizelltrains.com)

### CONNECTICUT

SHELTONRAILROADSYSTEMS  
SHELTON  
203-924-8761

[adriani@clearlight.com](mailto:adriani@clearlight.com)  
NEWENGLANDHOBBYSUPPLY  
MANCHESTER  
860-646-0610  
[bobbell@nehobby.com](mailto:bobbell@nehobby.com)

### DELAWARE

KRRBMODEL TRAINS INC.  
NEWARK  
302-292-2779  
[info@krrb.com](mailto:info@krrb.com)  
[www.krrb.com](http://www.krrb.com)

### FLORIDA

DEPOTHOBBIYSHOP  
LAKEWORTH  
561-585-1982  
[jimmy1982@aol.com](mailto:jimmy1982@aol.com)  
[www.depohobbies.com](http://www.depohobbies.com)

COLONIALPHOTO&HOBBY  
ORLANDO

407-841-1485  
[trains@colonialphotoandhobby.com](mailto:trains@colonialphotoandhobby.com)

WARRICKCUSTOMHOBBIES  
PLANTATION

954-370-0708  
[info@warrickcustomhobbies.com](mailto:info@warrickcustomhobbies.com)  
[www.warrickcustomhobbies.com](http://www.warrickcustomhobbies.com)

FRANK'S TRAINS & HOBBIES INC.

OLDSMAR  
813-855-1041  
[FTH@allhobbies.com](mailto:FTH@allhobbies.com)  
[www.allhobbies.com](http://www.allhobbies.com)

READYTOROLL

MIAMI  
305-688-8868  
[rttrains@aol.com](mailto:rttrains@aol.com)  
[www.readytorolltrains.com](http://www.readytorolltrains.com)

### ILLINOIS

BIKE&CHOOCHOO CONNECTION  
SCHAUMBURG  
847-882-7728  
[trainconnection@aol.com](mailto:trainconnection@aol.com)

### INDIANA

Y. O. R. K. TRAINS  
MUNSTER  
219-838-9999  
[yorktrains@aol.com](mailto:yorktrains@aol.com)

SAMUELSON'S TRAINSHOP

VALPARAISO  
219-462-2708

### LOUISIANA

AMERICA'S TRAINYARD  
BATON ROUGE  
225-926-5592

### MAINE

WHEELS, WINGS & THINGS  
LUDLOW  
207-532-6277  
[irc44@javanet.com](mailto:irc44@javanet.com)

### MARYLAND

ENGINEHOUSE HOBBIES  
GAITHERSBURG  
301-590-0816  
[luciecerise@aol.com](mailto:luciecerise@aol.com)

J&B TRAINS  
HAGERSTOWN  
240-420-4930

HOBBYTOWNUSA  
FREDERICK  
301-694-7395

PURKEY'S TOY TRAINS  
SYKESVILLE  
410-549-6061  
[wiley@oldmainline.com](mailto:wiley@oldmainline.com)

THE TRAIN ROOM  
HAGERSTOWN  
301-745-6681

### MASSACHUSETTS

NORTHEAST TRAINS  
PEABODY  
978-532-1615  
[www.netrains.com](http://www.netrains.com)

### MICHIGAN

BRASSEURELECTRICTRAINS INC.  
SAGINAW  
517-793-4753  
[bob@traindoctor.com](mailto:bob@traindoctor.com)  
[www.traindoctor.com](http://www.traindoctor.com)

**MISSOURI**  
SWITCHSTAND  
SAINTLOUIS  
314-781-4458  
r41877@earthlink.com

MARKTWINHOBBYCENTER  
ST. CHARLES  
636-946-2816  
webmaster@hobby1.com  
www.hobby1.com

**NEWHAMPSHIRE**  
TREASUREDTOYS  
SALEM  
603-898-7224  
ttoys@treasured-toys.com  
www.treasured-toys.com

RAILROADSPECIALTIES  
HUDSON  
603-882-5566  
crew@electric-trains.com  
www.electric-trains.com

**NEWJERSEY**  
TRAINS&THINGS  
TRENTON  
609-883-8790  
trainsanthings@aol.com

GRANDCENTRALSTATION  
KEARNY  
201-955-6200  
228gene@gateway.com

HOBBYMASTERS,INC  
REDBANK  
732-842-6020  
hobbymasters@hobbymasters.com

HOLLYBEACHTRAINDEPOT  
WILDWOOD  
609-522-2379  
larry@pro-usa.net

COASTTRAINSANDCOLLECTIBLES  
WALL  
732-556-9005  
coasttrain@aol.com  
www.coasttrains.com

J&BTRAINS, INC.  
MAPLESHADE  
856-414-0092  
BASE1130@aol.com

HOBBYSHOP  
MATAWAN  
732-583-0505  
hobbyshopnj.com

ATLANTICRAILS  
HAMMONTON  
609-567-8490  
bobcap@pics.com  
www.atlanticrails.com

COUNTRYAND STUFF  
ANDOVER  
973-786-7086  
stuff@crystal.palace.net

RIDGEFIELDHOBBY  
RIDGEFIELD  
201-943-2636

COLUMBUSTRAINSTATION  
COLUMBUS  
609-518-1800

**NEWYORK**  
AURORARAILS&HOBBIES  
EASTAURORA  
716-652-5718  
rk82141@aol.com

AMERICANASTORE  
TIVOLI  
845-757-4246  
mthdepot@vals tar.net

NASSAUHOBBYCENTER, INC.  
FREEPORT  
516-378-9594  
Charlienassau@aol.com

KROSS HARDWARE  
WESTBABYLON  
631-669-3069  
t989@aol.com

CITYDEPOT, INC.  
NEWHAMPTON  
845-374-3010  
citydepot@frontiernet.net  
www.citydepot.com

**NORTHCAROLINA**  
DRYBRIDGESTATION  
MOUNTAIRY  
336-786-9811  
mikek@drybridgestation.com  
www.drybridgestation.com

THEFREIGHTYARD  
SMITHFIELD  
919-934-6229  
disbissette@aol.com

TRAINS LTD.  
CHARLOTTE  
704-566-9070  
modelrfs@bellsouth.net  
www.trainsltd.com

THEROUNDHOUSE&BACKSHOP  
CARY  
919-465-0810

**OHIO**  
DIXIEUNIONSTATION  
MASON  
513-459-0460  
rockylane@core.net  
www.dixieunionstation.com

RICK'STOYTRAINS  
TOLEDO  
419-478-0171

T&KHOBBYSHOP  
BRIDGEPORT  
740-633-6607  
salea@tkhobbies.com  
www.tkhobbies.com

TRAINS-N-THINGS  
CANTON  
330-499-1666  
trains@sssnnet.com

PARMAHOBBY  
CLEVELAND  
216-741-6440  
info@parmahobby.com

GLEN'STRAINSHOP  
AKRON  
330-253-6527

E&STRANS  
AKRON  
330-745-0785

GRANDPACIFICJUNCTION  
OLMSTEAD FALLS  
440-235-4777  
gpjmrr@juno.com  
HUDSONTOY, TRAIN&HOBBY  
HUDSON  
330-653-2997  
ejpickens@aol.com

DAVISELECTRONICS  
MILFORD  
513-831-6425  
davisstrains@fuse.net  
www.davisstrains.com

SANDY'SHOBBY'S&COLLECTIBLES  
ELYRIA  
440-365-9999  
sandyshobb@aol.com

ERIE RAILWAYDEPOT  
TROY  
937-440-9972  
orville@gte.net

CLEARVIEW TRAIN&HOBBY  
LORAIN  
440-277-4488  
klogar@erienet.net  
www.clearviewtrainandhobby.com

**PENNSYLVANIA**  
FAIRCHANCEPHARMACY  
FAIRCHANCE  
724-564-7817  
mthdealer@aol.com  
www.hhs.net/fairchance

**THESTATION**

NEWCUMBERLAND  
717-774-7096

station@paonline.com  
BUSSINGERTRAINS  
AMBLER

215-628-2366  
choochoos@icdc.com  
www.icdc.com/~btrains

**CHARLEROISSWEeperCENTER**

CHARLEROI  
724-483-3397

**AMERICANHOBBYCENTER**

ALIIQUIPPA  
724-378-3930  
american@icubed.com

**CRANBERRYHOBBYDEPOT**

CRANBERRYTWP  
724-776-3640  
JAdams6113@aol.com

**ALLENTOWNTOYTRAIN SERVICE**

ALLENTOWN  
610-821-0740

**ONTHERIGHTTRACK**

ALTOONA  
814-942-4345

**JIM'STRAINSHOP**

HOMERCITY  
724-479-2026  
sudsy@stargate.net

**YEOLDETRAIN&CHRISTMAS**

SHOPPE  
BOYERTOWN  
610-369-0755  
www.yeoldetrain.com

**TOBYTYLER'S HOBBYCENTER**

PITTSBURGH  
412-653-5030  
tobytyler111@cs.com

**BUSTLETONTAINSHOP**

PHILADELPHIA  
215-698-7266

**CHESTNUTTOYBOX**

PHILADELPHIA  
215-545-0455  
chestnuttoy@earthlink.net

**THECABOOSE**

LEHIGHTON  
570-386-5352  
www.thecaboosehobbies.com  
victen@ptd.net

**SOUTHCAROLINA**

EMERALD TRAIN & HOBBY  
GREENWOOD  
864-223-2247

**TENNESSEE**

MODEL RAILROAD&HOBBYSHOP  
MEMPHIS

901-384-6500  
mrhs99@earthlink.net  
www.modelrailroadandhobby.com

**TEXAS**

HOBBY TIME  
AMARILLO  
806.352.9660  
don.l.harris.@hobby-time.com

**VIRGINIA**

TRAINDEPOT  
MANASSAS  
703-335-2216

**NORGE STATION**

WILLIAMSBURG  
757-564-7623  
norgetrains@cs.com

**NUTBUSHEXPRESS**

VICTORIA  
804-696-1902  
thenutbushexp@meckcom.net

**TOYTRAINCENTER**

RICHMOND  
804-288-4475

**TSGHOBBIES**

WARRENTON  
540-347-9212  
triji@mnsinc.com  
www.mnsinc.com/triji/tsg.htm

**CHESTERFIELDHOBBIES**

MIDLOTHIAN  
804-379-9091  
chsthobb@erols.com  
www.chesterfieldhobbies.com

**DAVIS HOBBYSUPPLIES**

PORTSMOUTH  
757-397-1983  
ralph@davishobby.com  
www.davishobby.com

**LOCUSTGROVETRAINS**

LOCUSTGROVE  
540-854-8955  
lgtrains@aol.com  
www.locustgrovetrains.com

**WESTVIRGINIA**

PATRICK'S TRAINS  
WHEELING  
304-232-0714  
trains@patstrains.com  
www.patstrains.com

**WISCONSIN**

SOMMERFELD'S TRAINS  
BUTLER

262-783-7797  
questions@sommerfelds.com  
www.sommerfelds.com

**GB TV& TRAINS**

GREENBAY  
920-496-9697  
rrtycoon@netnet.net

**GRAMPA'S TRAINSHOP**

RICE LAKE  
715-234-2996  
grampastrains@aol.com

**THE TRAINSTORE**

WAUKESHA  
262-650-6675

**HOBBYOUTLET**

FONDDULAC  
920-924-3770  
hobby\_outlet@hotmail.com

**CANADA****ONTARIO****CREDIT VALLEY RAILWAY COMPANY**

STREETSVILLE  
905-826-1306  
CVRCO@globalserve.net  
www.cvrco.com

**TOY TRAINWORKSHOP**

CUMBERLAND  
613-833-3125  
info@toytrainworkshop.com  
www.toytrainworkshop.com

**THE TRAINROOM**

FERGUS  
519-787-3280